

APPENDIX B

2008 RARE PLANT MONITORING REPORT

REPORT ON WEED CONTROL SEGMENT TREATMENTS

SPRING 2008

Prepared by:

Sean McStay, Fort Ord Natural Reserve Steward

Gage Dayton, Fort Ord Natural Reserve Director

TABLE OF CONTENTS

Introduction.....	3
Methods.....	3
Results.....	4
Discussion.....	4

TABLES

Table 1. Summary of Weed Control Segment (WCS) treatments, Spring 2008.	6
Table 2. Invasive species treated on the 12 HGL well sites and associated access roads within the OU1 groundwater cleanup sites on the Fort Ord Natural Reserve, spring, 2008.	7

ATTACHMENTS

- Attachment 1 – Treatment Diagrams
- Attachment 2 – Photo Log
- Attachment 3 – Photographs (compact disc)

Introduction

The scope of the 2008 Weed Control Segment (WCS) project was considerably less than the 2007 WCS project. The 2008 effort was scaled back for several reasons, such as significant staffing changes within UC Fort Ord Natural Reserve (FONR) and cost overrun during the 2007 project implementation. In addition, there were delays in revising and accepting the 2008 Scope of Work. These changes affected the timeline of the entire WCS project, which postponed the hiring and training of staff to perform treatments. As such, the timeline and reduced scope of the 2008 WCS project resulted in several changes from the 2007 project. This reduced scope resulted in a considerably smaller project budget compared to 2007. Specifically, a comprehensive vegetation survey (e.g. cover data) of each WCS was not conducted this year. It is our opinion that these comprehensive vegetation surveys are not necessary each year and are not required to conduct WCS treatments. The vegetation surveys are intended to evaluate success of WCS treatments, which might not be evident within one year. Other differences in the methodology, in comparison to 2007, include reduced number of treatments per WCS, different treatment methods, and reduced number of species treated.

Methods

WCS treatments began 21 May 2008 and continued through 21 August 2008. Each WCS received between 1-5 treatments depending on site-specific phenology, response to treatments, and species composition at each site. Most WCS were treated only once. Two WCS (13A and 16A) received multiple treatments. Prior to the initial treatment, pre-treatment photos were taken from appropriate photo stations within each WCS. After performing a treatment, a WCS treatment record and a WCS treatment diagram were completed. The WCS treatment record includes: treatment date,

initials of person conducting treatment, treatment method(s), species treated, treatment duration, photo stations, and any additional notes. The WCS treatment diagram includes the extent of the treatment and the species treated within the site. These diagrams, although not drawn to scale, also show the spatial extent, well location, well site/road boundaries, and photo stations/points for each WCS. After performing the final treatment of the season, post-treatment photos were taken from appropriate photo stations within each WCS.

Results

Although our overall efforts were somewhat reduced from 2007 we still had a major impact on removing weeds from well sites and access roads. In comparison to 2007, we focused on fewer sites of higher priority and devoted approximately 7 additional hours in 2008 to weed control efforts. We visited sites 1-5 times and used hand pulling, clipping, and shovels to remove priority target weeds (Tables 1 & 2). Along with this report, we have included the following documentation:

- treatment diagrams (described above; Attachment 1)
- detailed photo log (Attachment 2).
- pre- & post treatment photos (Attachment 3 – on compact disc)

Discussion

The delayed project implementation prevented most annual grass treatments because many of the grasses were already producing seed. Using a brushcutter to treat a WCS late in the life cycle of the grasses would spread seed and defeat the purpose of the treatment. As a result, only manual control methods were utilized in 2008 which allowed us to avoid potential rare plant impacts while performing limited weed control treatments. The avoidance of mechanical treatments meant that fewer sites could be effectively treated because many of the areas only have annual grasses invading (i.e. other priority weed species were not present in many of the sites). Consequently, the 2008 effort

focused on controlling invasive forbs and devoted minimal time to control of annual grasses.

Although the delayed timing of the project resulted in missing the opportunity for controlling the majority of annual grasses, we were able to remove thousands of invasive weeds from the well sites.

As a result, our efforts reduced the number of invasive plants and, importantly, removed a large portion of the invasive weed seed source for 2009.

DRAFT

Table 1. Summary of Weed Control Segment (WCS) treatments, Spring 2008.

WCS	Well ID	# of Treatments	Time (hrs)	Treatment Method	Species Treated	WCS of High Concern*
4A	IW-OU1-05-A	1	0.05	hand pull	brdi, brmaru	*
5A	IW-OU1-01-A	1	3	hand pull, shovel, machete	brca, ceme	*
6A	EW-OU1-53-A	1	1	hand pull	brdi, brho, coma, sima	*
7A	EW-OU1-52-A	1	0.2	hand pull	coma	
9A	MW-OU1-46-AD PZ-OU1-46-AD2	1	1	hand pull, clippers	coma	
9B	MW-OU1-84-A	1	0.25	hand pull, clippers	coma	
10A	MW-OU1-50-A	1	2.1	hand pull	coma, capy, avsp, brdi, brho	
10B	MW-OU1-59-A	1	2.5	hand pull hand pull,	capy, coma	
13A	IW-OU1-73-A	5	15.25	clippers, shovel	capy, coma	*
14A	MW-OU1-83-A	1	4.5	hand pull	coma	*
15A	MW-OU1-82-A	1	0.5	hand pull hand pull,	capy	*
16A	SB-OU1-2004-K	3	11.25	clippers	capy, coma	*

***High Concern WCS** – this classification represents a subjective judgment based on a number of factors, including (among others) the number and frequency of treatments, observed response to treatments, and the species composition of the site.

Table 2. Invasive species treated on the 12 HGL well sites and associated access roads within the OU1 groundwater cleanup sites on the Fort Ord Natural Reserve, spring, 2008.

Genus	species	Code	Common Name
<i>Avena</i>	<i>species</i>	avsp	wild oat species (Note: species not identified – avsp includes both <i>Avena barbata</i> and <i>A. fatua</i>)
<i>Bromus</i>	<i>catharticus</i>	brca	Prairie Grass
<i>Bromus</i>	<i>diandrus</i>	brdi	Rippgut grass
<i>Bromus</i>	<i>hordeaceus</i>	brho	Soft Chess
<i>Bromus</i>	<i>madritensis ssp. rubens</i>	brmaru	Red brome
<i>Carduus</i>	<i>pycnocephalis</i>	capy	Italian Thistle
<i>Centaurea</i>	<i>melitensis</i>	cema	Tocalote
<i>Conium</i>	<i>maculatum</i>	coma	Poison Hemlock
<i>Silybum</i>	<i>marianum</i>	sima	Milk Thistle

DRAFT

Attachment 1

‘TREATMENT DIAGRAMS 2008’

The attached diagrams show the extent of the treatment and the species treated within each site for the 2008 weed control program within the Operable Unit 1 portion of the FONR. These diagrams (not drawn to scale) also show the spatial extent, well location, well site/road boundaries, and photo stations/points for each Weed Control Segment.

Well ID:

IW-OUI-05A

Date

5-21-08

WCS Sub Group

4A

Surveyor

STM, AFM

Total Aprox. Area

94 (m²)

Well Rd. Area

48 (m²)

Well Site Area

46m (m²)

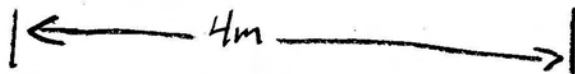

Legend

- IA # = WCS Sub Group
- P Photo Station
- Photo Point
- ⊕ Well
- - - Well Road/Site boundary
- · · WCS boundary

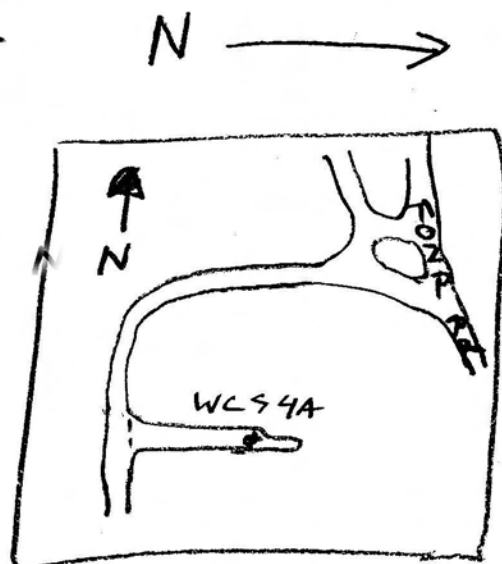
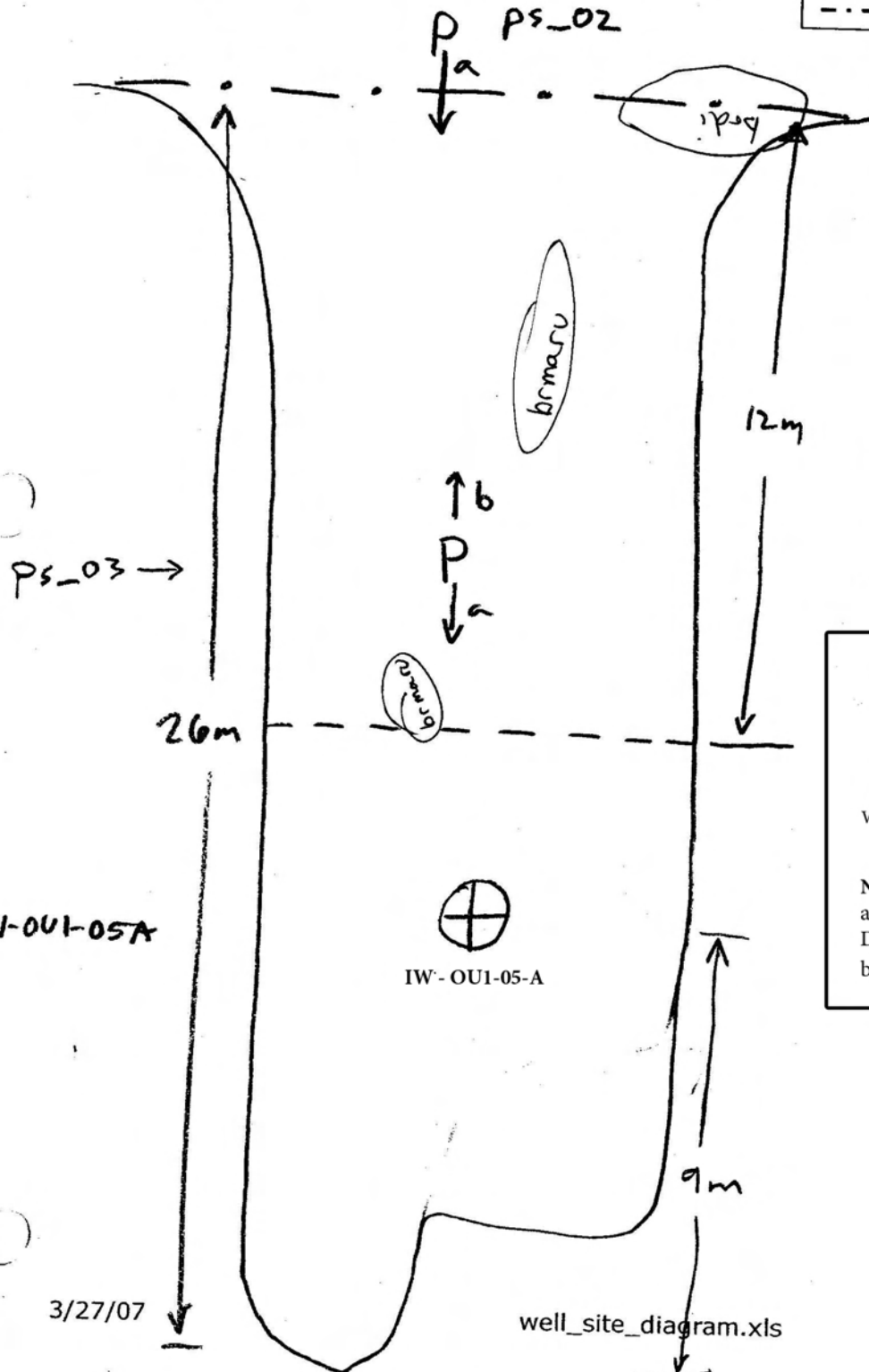

Treatment Key

- ceme → Weed Type
- → Boundary of Treated Area

NOTE: Photo station ID labels (e.g. ps_01) are placed near photo station locations (P). Direction of photo (i.e. photo point) is labeled with arrow and letter (e.g. P_a -->)

3/27/07

well_site_diagram.xls

Well ID: IW-001-01-A

Date 5-21-08

WCS Sub Group 5-A

Surveyor STM, AFM

Total Aprox. Area 240 (m²)

Well Rd. Area 174 (m²)

Well Site Area 56 (m²)

Legend

- IA # = WCS Sub Group
- P Photo Station
- Photo Point
- ⊕ Well
- - - Well Road/Site boundary
- . . . WCS boundary

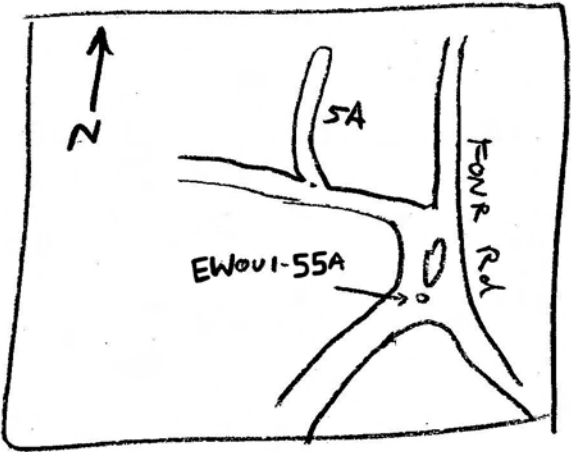

Treatment Key

Boundary of Treated Area

Weed Type

NOTE: Photo station ID labels (e.g. ps_01) are placed near photo station locations (P). Direction of photo (i.e. photo point) is labeled with arrow and letter (e.g. P_a -->)

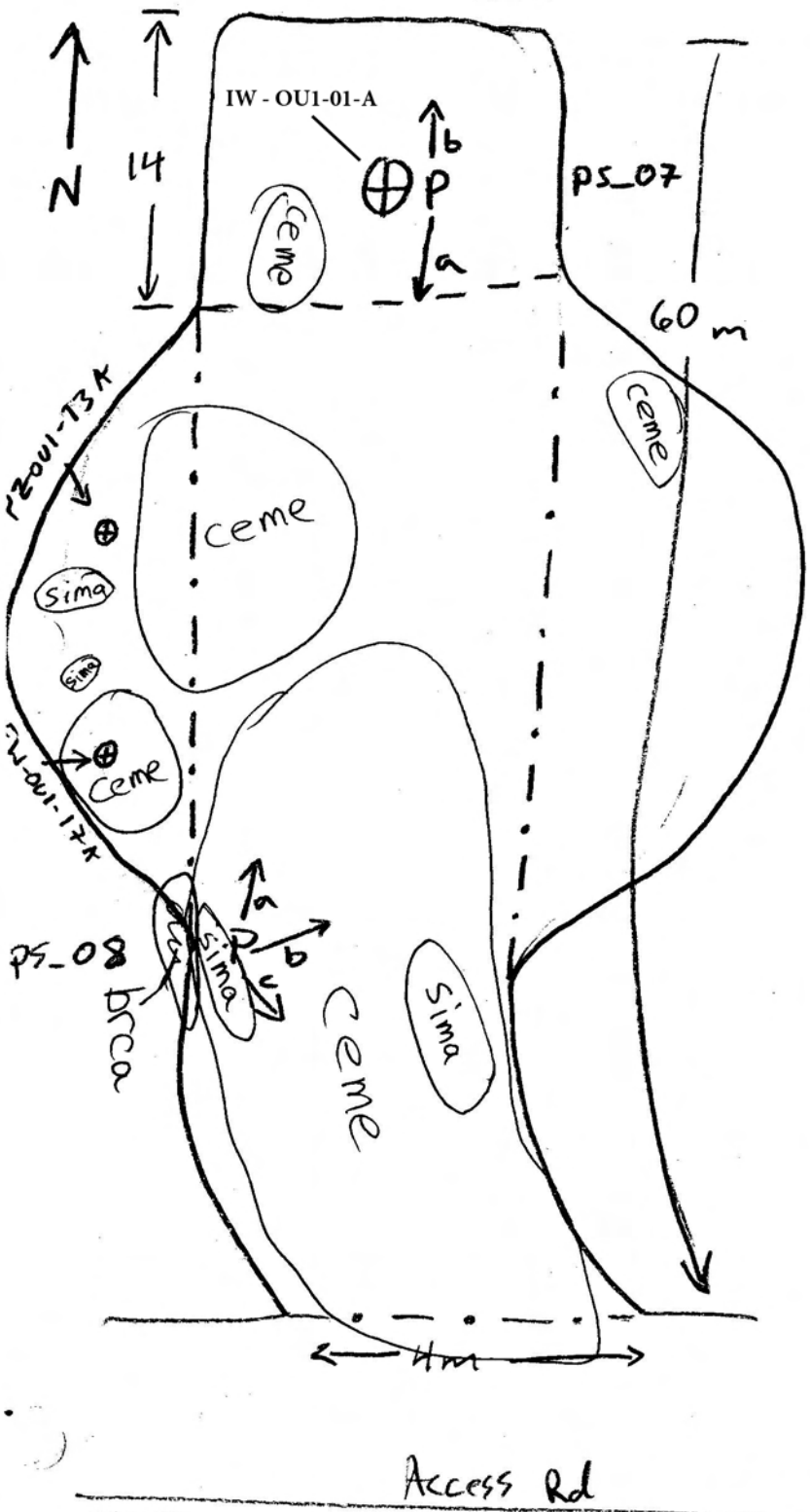

Well ID:

EW-001-53-A

Date

S-21-08

WCS Sub Group

6A

Surveyor

STM, AFM

Total Aprox. Area

220 (m²)

Well Rd. Area

138 (m²)

Well Site Area

82 (m²)

Legend

1A # = WCS Sub Group

P Photo Station

→ Photo Point

⊕ Well

--- Well Road/Site boundary

.... WCS boundary

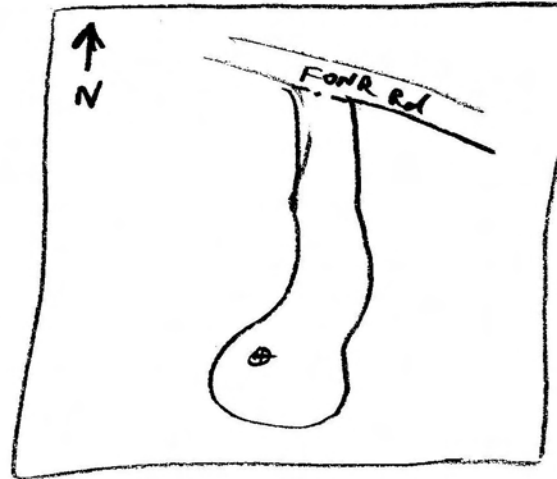
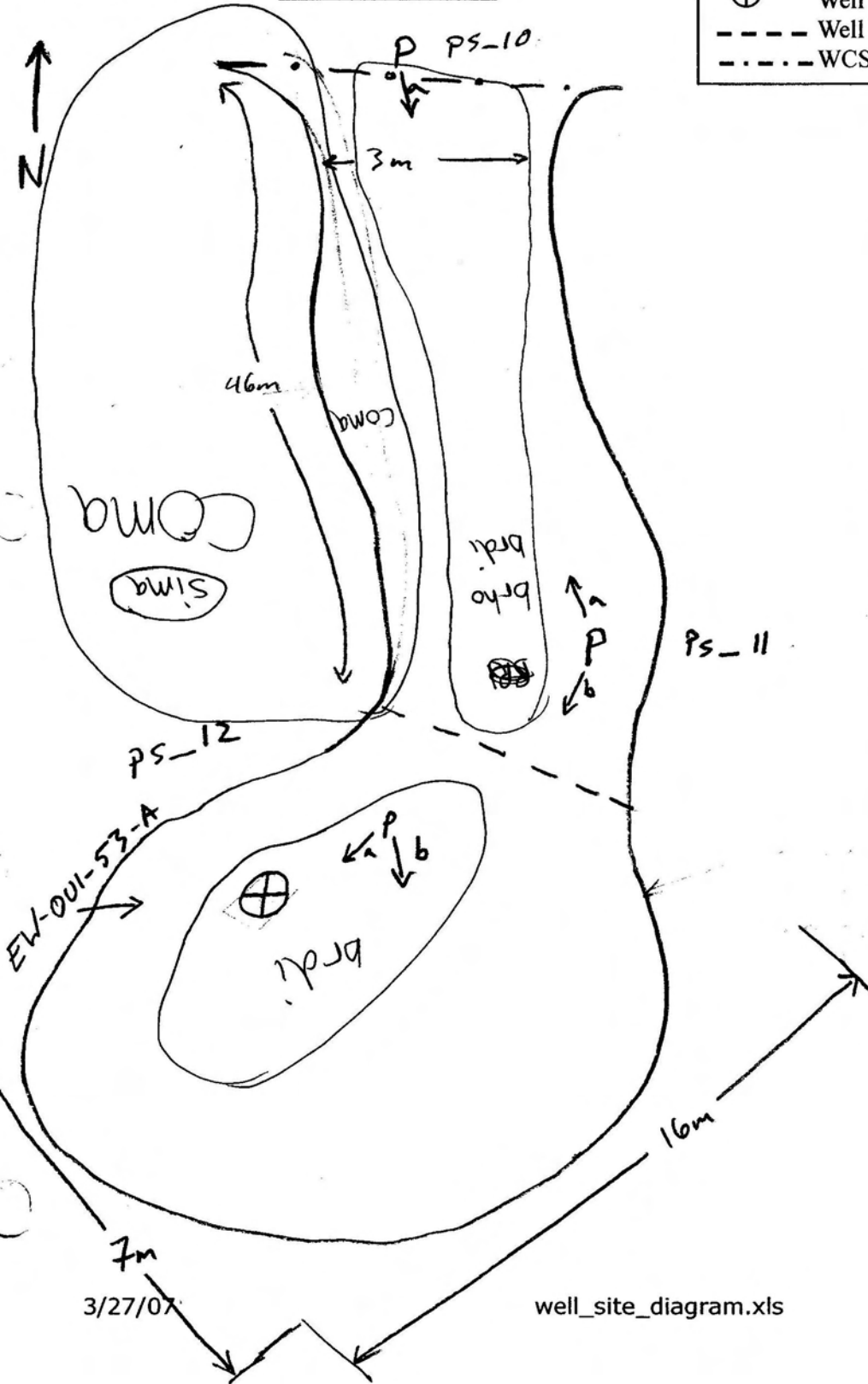

Treatment Key



NOTE: Photo station ID labels (e.g. ps_01) are placed near photo station locations (P). Direction of photo (i.e. photo point) is labeled with arrow and letter (e.g. P_a -->)

Well ID: EW-OU1-52A

Date 5-21-08

WCS Sub Group 7A

Surveyor STM, AFM

Total Aprox. Area 164 (m²)

Well Rd. Area 120 (m²)

Well Site Area 44 (m²)

Legend

- IA # = WCS Sub Group
- P Photo Station
- Photo Point
- ⊕ Well
- - - Well Road/Site boundary
- · · · · WCS boundary

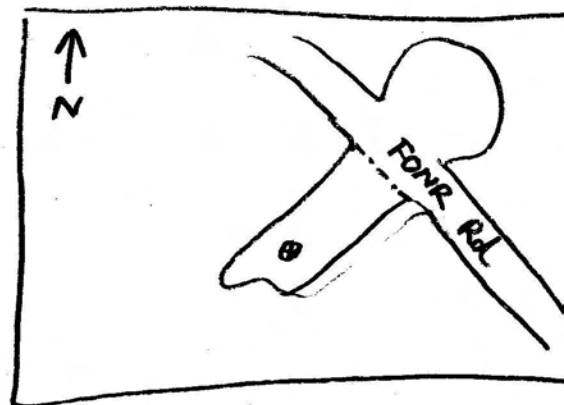

Treatment Key

Boundary of Treated Area

Weed Type

NOTE: Photo station ID labels (e.g. ps_01) are placed near photo station locations (P). Direction of photo (i.e. photo point) is labeled with arrow and letter (e.g. P_a -->)

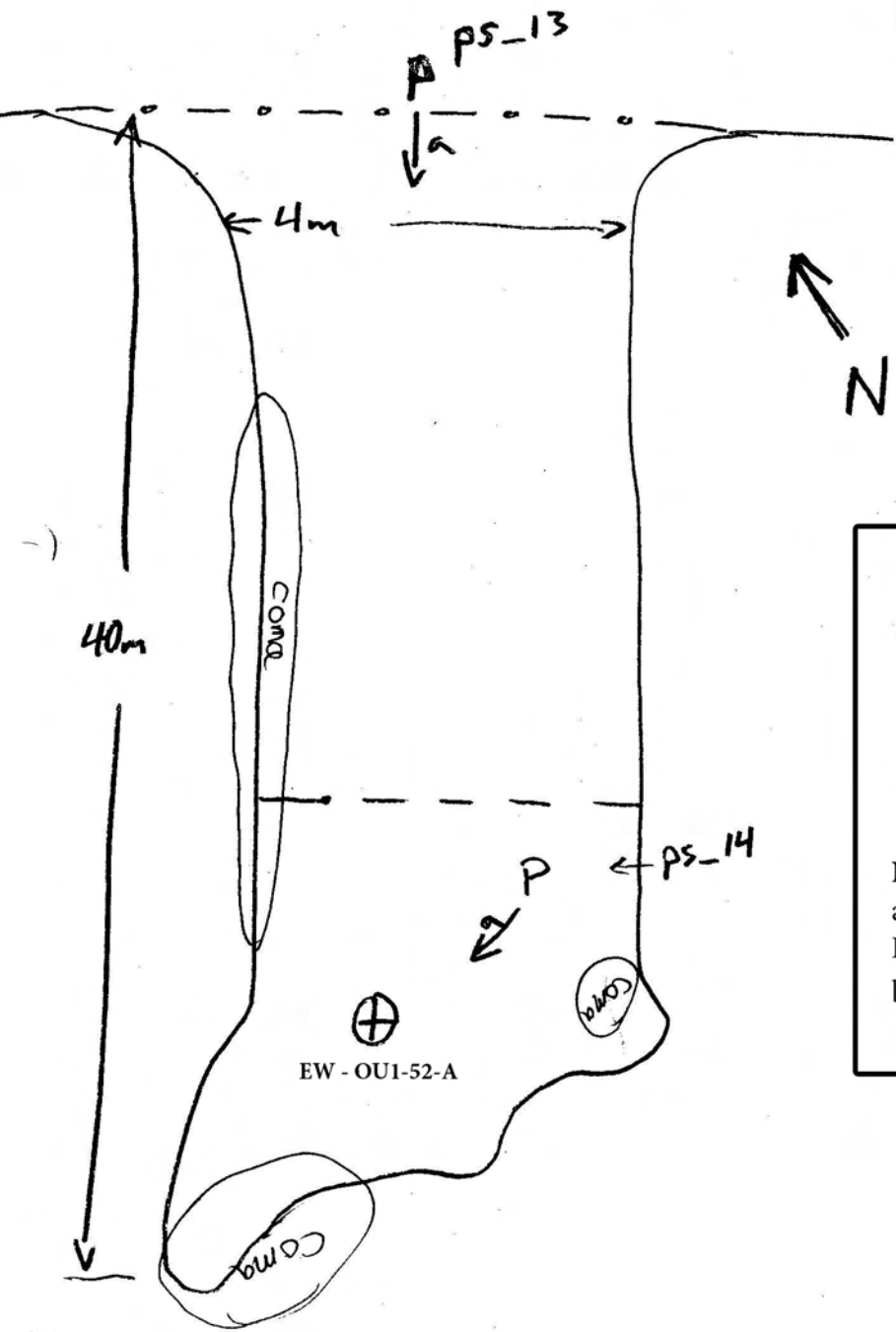

Well ID: MW-001-46AD, PZ-001-46-AD2, MW-001-46-AW
 WCS Sub Group: 9A
 Total Aprox. Area: 369 (m²)
 Well Rd. Area: 256 (m²)
 Well Site Area: 113 (m²)

Date: 5-28-08
 Surveyor: AFM



Legend

- IA # = WCS Sub Group
- P Photo Station
- Photo Point
- ⊕ Well
- - - Well Road/Site boundary
- . - . - WCS boundary

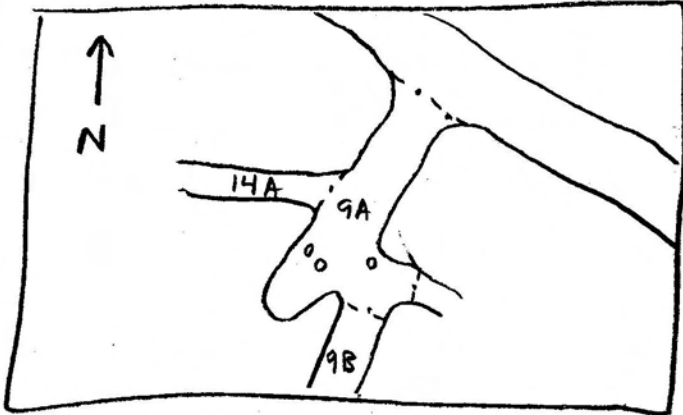

Treatment Key

Boundary of Treated Area

ceme

Weed Type

NOTE: Photo station ID labels (e.g. ps_01) are placed near photo station locations (P). Direction of photo (i.e. photo point) is labeled with arrow and letter (e.g. P_a -->)

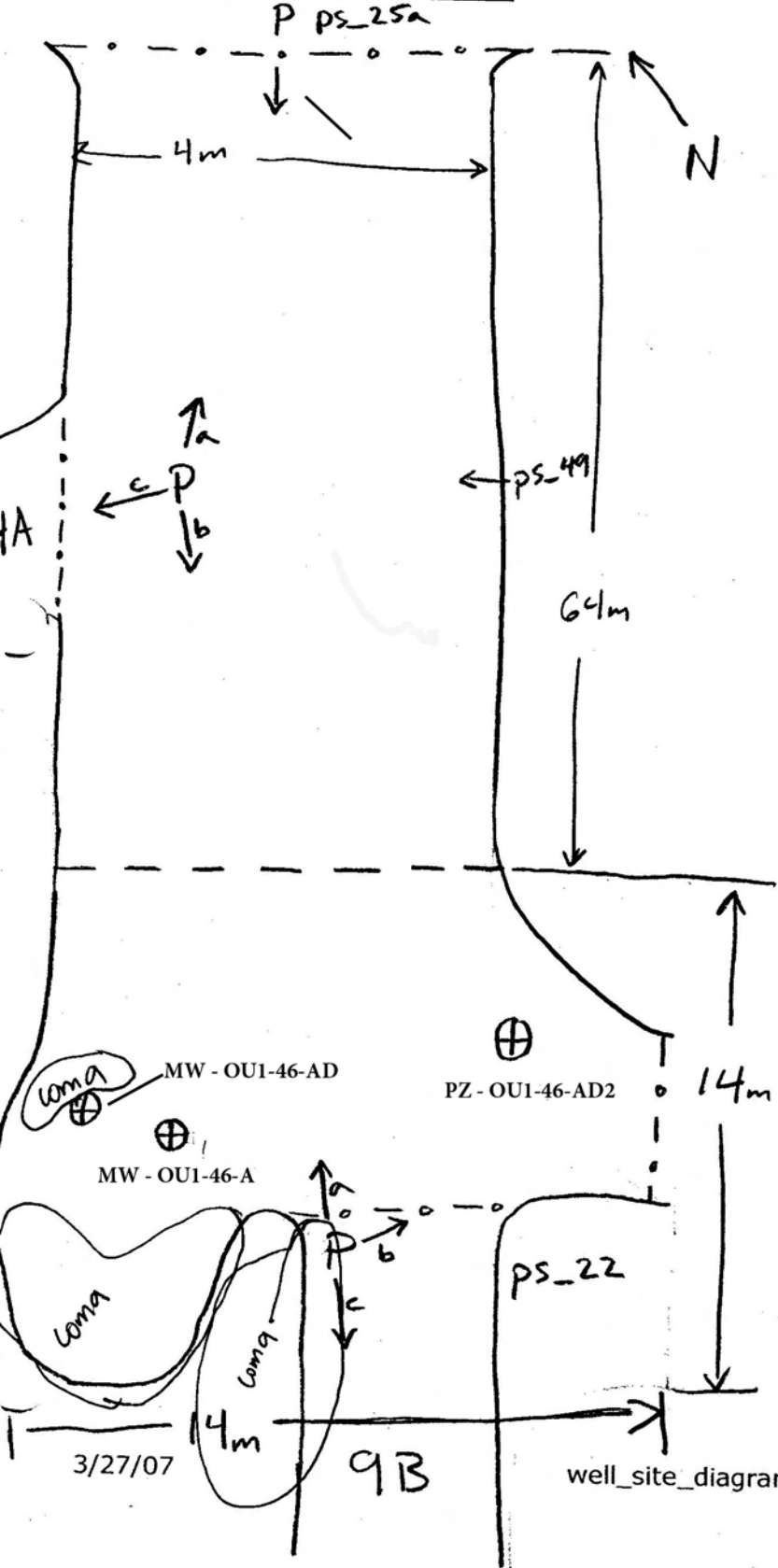

Well ID: MW-OUI-84A
 WCS Sub Group 9B
 Total Aprox. Area 304 (m²)
 Well Rd. Area 64 (m²)
 Well Site Area 240 (m²)

Date 5-28-08
 Surveyor AFM

Legend

- 1A # = WCS Sub Group
- P Photo Station
- Photo Point
- ⊕ Well
- - - Well Road/Site boundary
- . . . WCS boundary

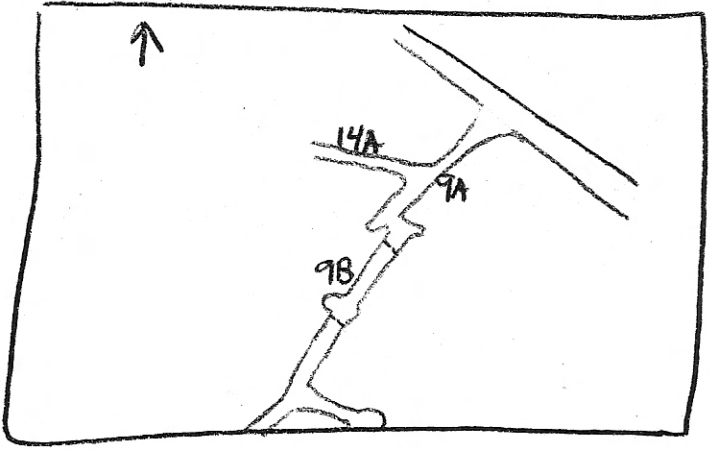

Treatment Key

A diagram showing an oval labeled 'ceme' with an arrow pointing to it from the text 'Weed Type'. Another arrow points to the boundary of the oval from the text 'Boundary of Treated Area'.

NOTE: Photo station ID labels (e.g. ps_01) are placed near photo station locations (P). Direction of photo (i.e. photo point) is labeled with arrow and letter (e.g. P_a -->)

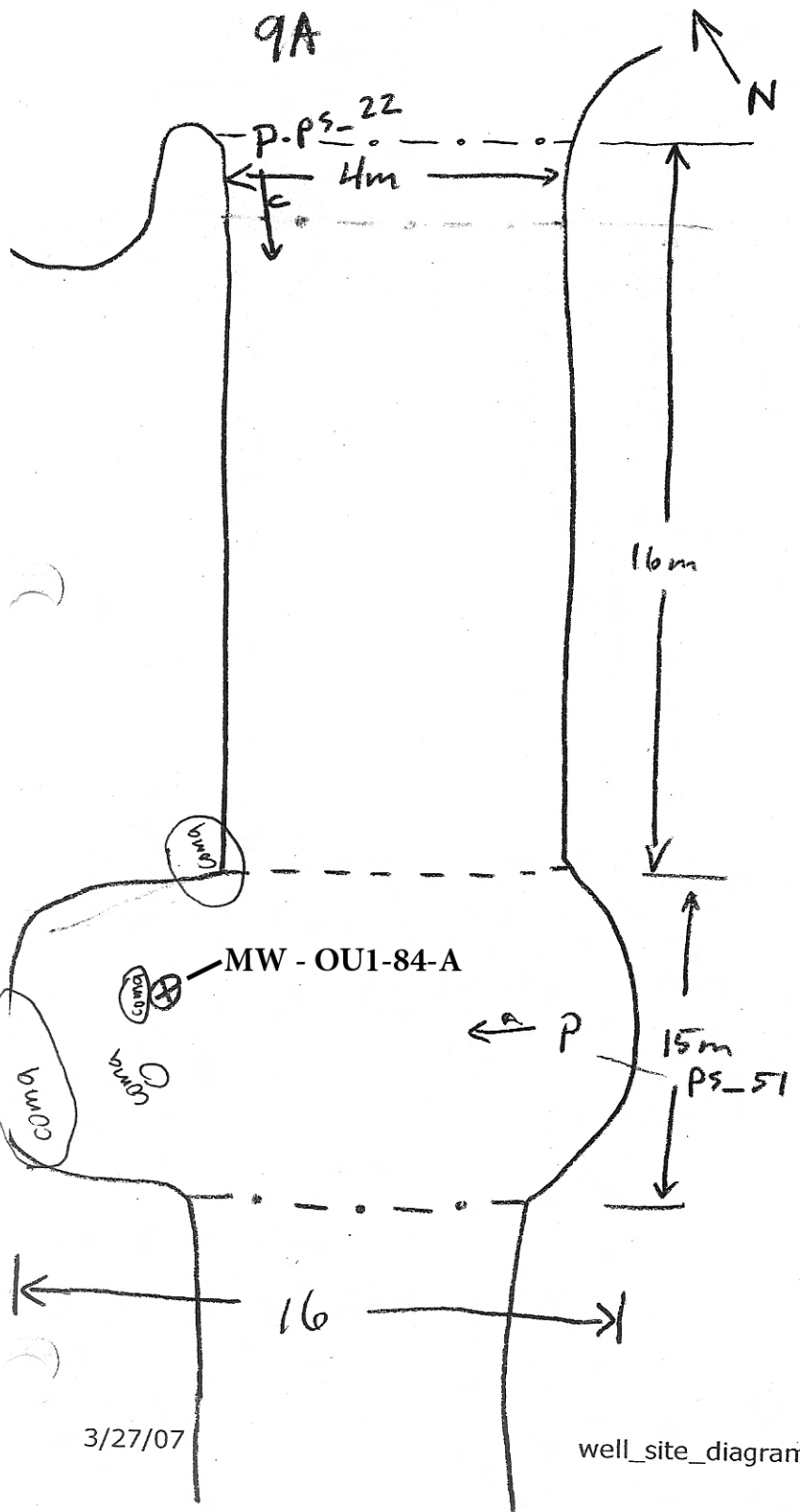

Well ID: MW-OUI-50A
 WCS Sub Group 10A
 Total Aprox. Area 120 (m²)
 Well Rd. Area 87 (m²)
 Well Site Area 33 (m²)

Date 5/27/08
 Surveyor STM, AFM

Legend

- IA # = WCS Sub Group
- P Photo Station
- Photo Point
- ⊕ Well
- - - Well Road/Site boundary
- . . . WCS boundary

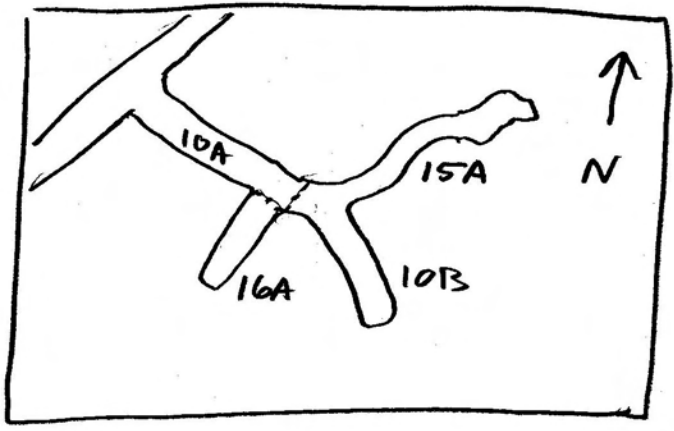

Treatment Key

Boundary of Treated Area

ceme

Weed Type

NOTE: Photo station ID labels (e.g. ps_01) are placed near photo station locations (P). Direction of photo (i.e. photo point) is labeled with arrow and letter (e.g. P_a -->)

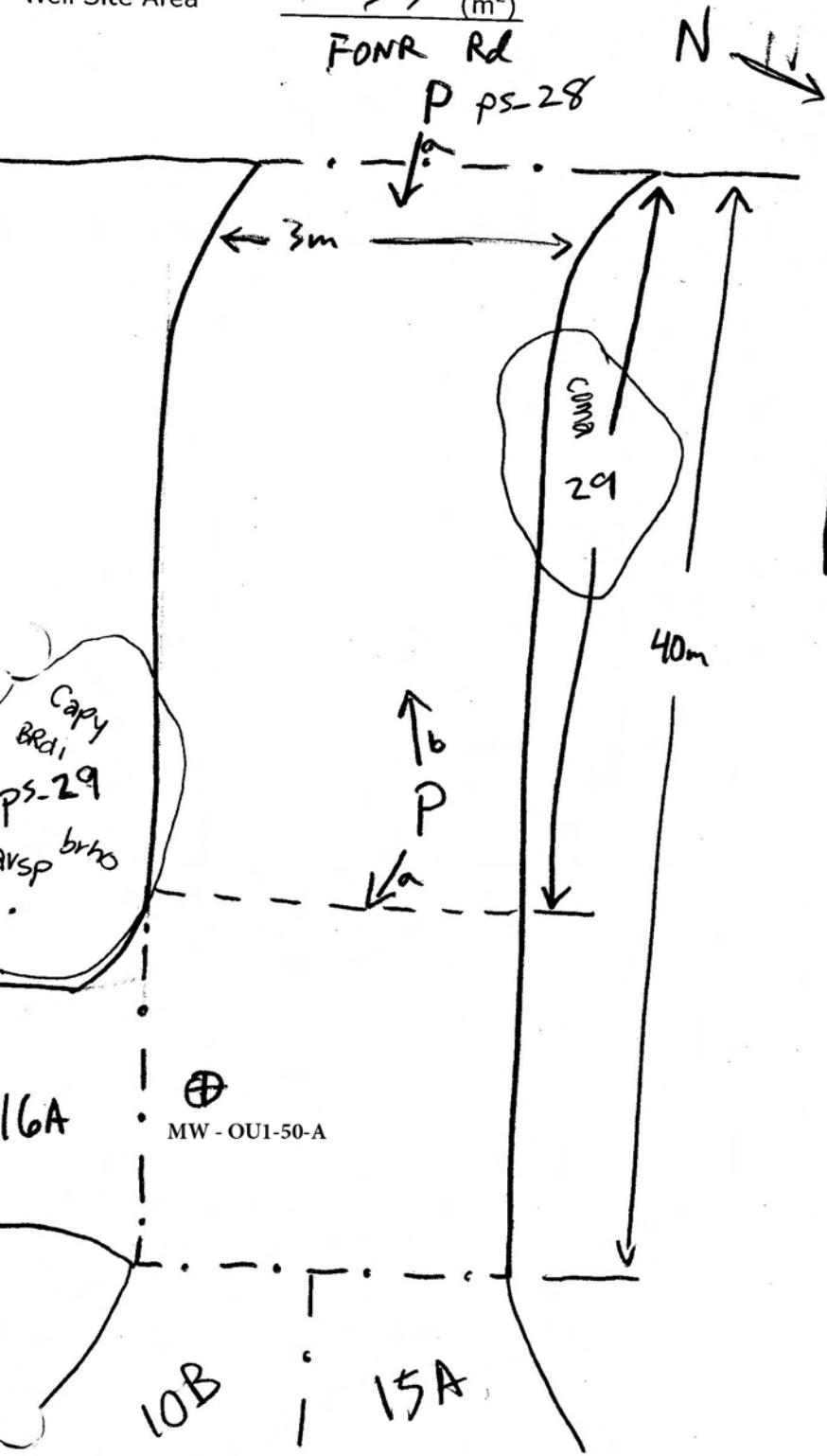

Well ID: MW-OUI-59A

Date 5/27/09

WCS Sub Group 10B

Surveyor STM, ARM

Total Aprox. Area 147 (m²)

Well Rd. Area 87 (m²)

Well Site Area 60 (m²)

Legend

- 1A # = WCS Sub Group
- P Photo Station
- Photo Point
- ⊕ Well
- - - Well Road/Site boundary
- . - . WCS boundary

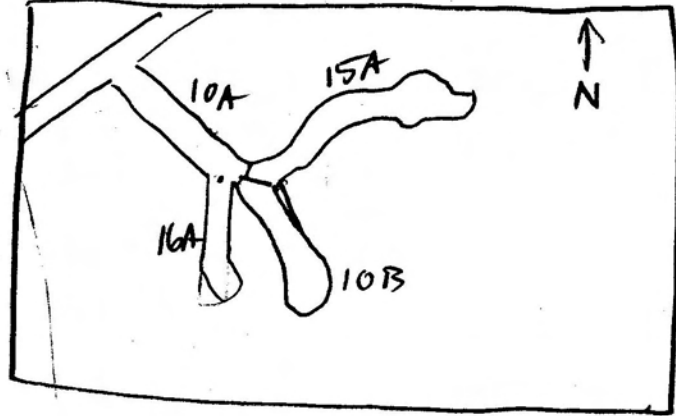

Treatment Key

NOTE: Photo station ID labels (e.g. ps_01) are placed near photo station locations (P). Direction of photo (i.e. photo point) is labeled with arrow and letter (e.g. P_a -->)

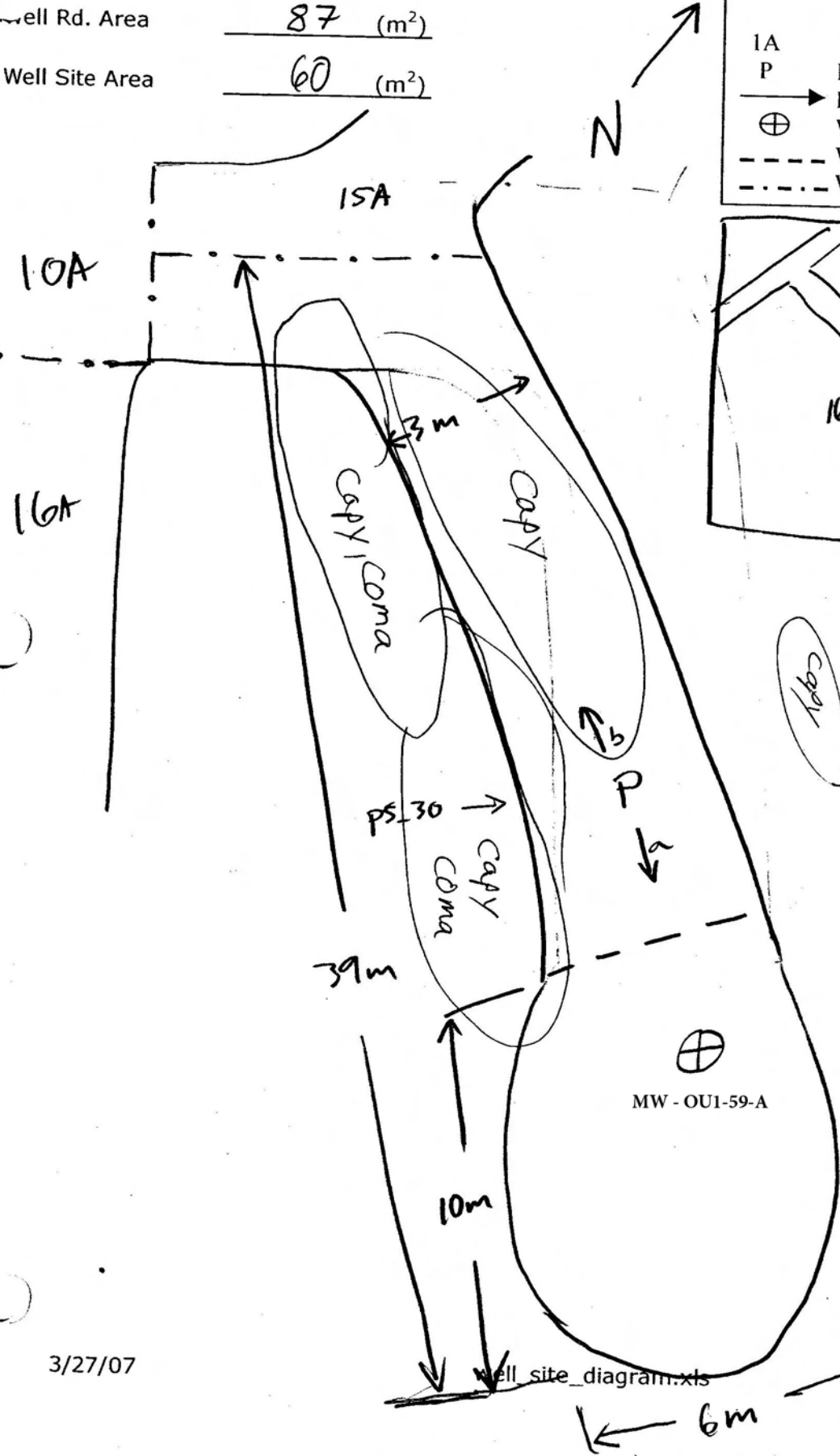

Well ID: IW-001-73A
 WCS Sub Group: 13A
 Total Aprox. Area: 277 (m²)
 Well Rd. Area: 150 (m²)
 Well Site Area: 127 (m²)

Date: 5-28-08
 Surveyor: AFM



Legend

- 1A # = WCS Sub Group
- P Photo Station
- Photo Point
- ⊕ Well
- - - Well Road/Site boundary
- . - . - WCS boundary

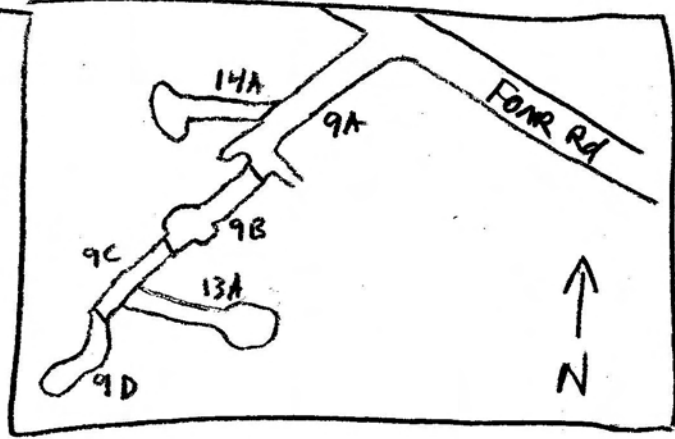
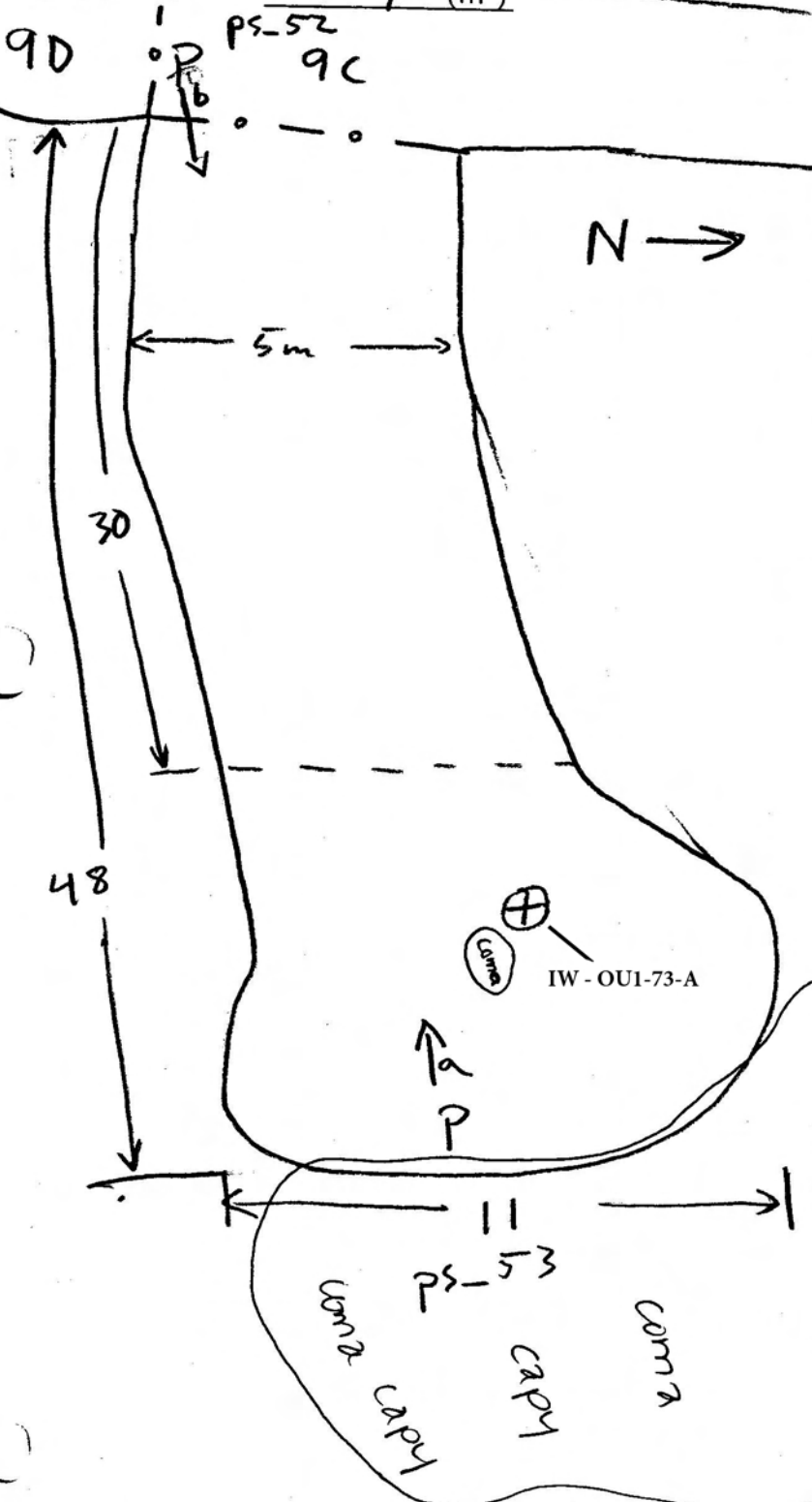

Treatment Key

Boundary of Treated Area

ceme

Weed Type

NOTE: Photo station ID labels (e.g. ps_01) are placed near photo station locations (P). Direction of photo (i.e. photo point) is labeled with arrow and letter (e.g. P_a -->)

Well ID: MW-OUI-83A
 WCS Sub Group 14A
 Total Aprox. Area 327 (m²)
 Well Rd. Area 215 (m²)
 Well Site Area 112 (m²)

Date 5-28-08
 Surveyor AFM

Legend

1A	# = WCS Sub Group
P	Photo Station
→	Photo Point
⊕	Well
---	Well Road/Site boundary
----	WCS boundary

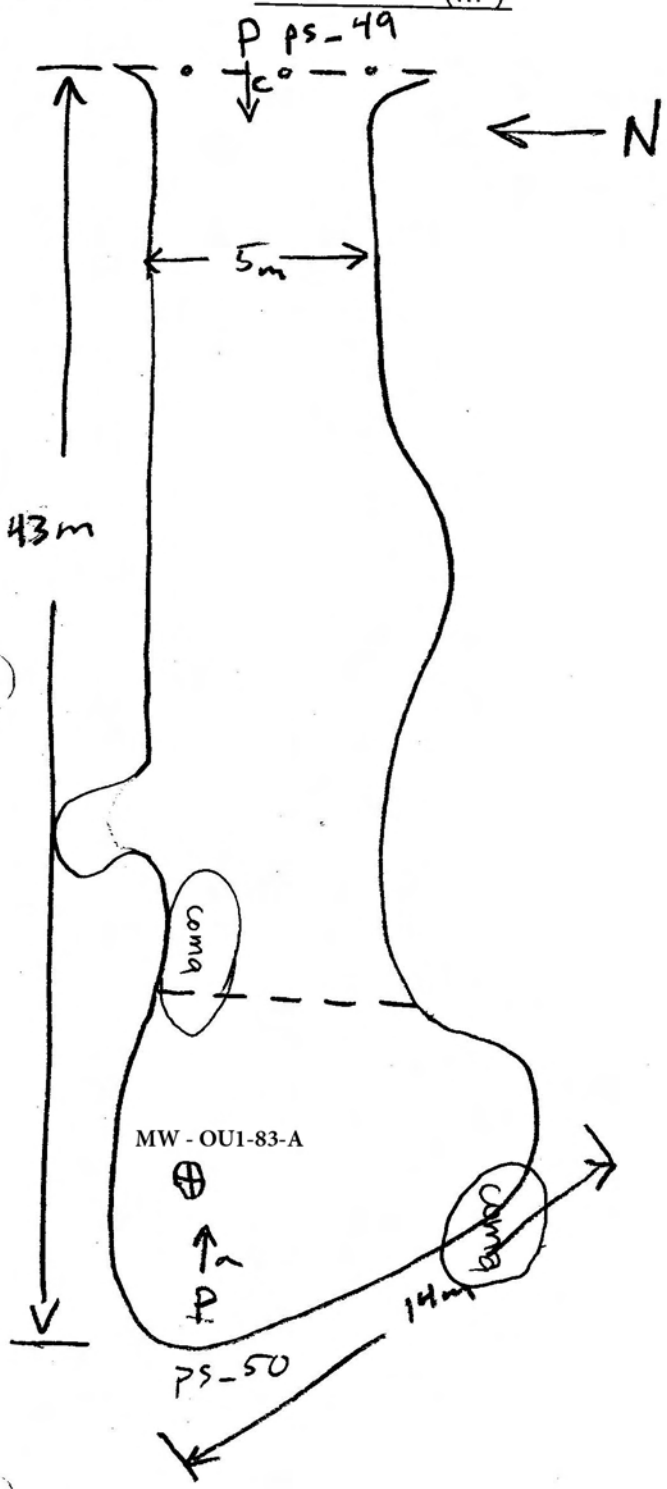
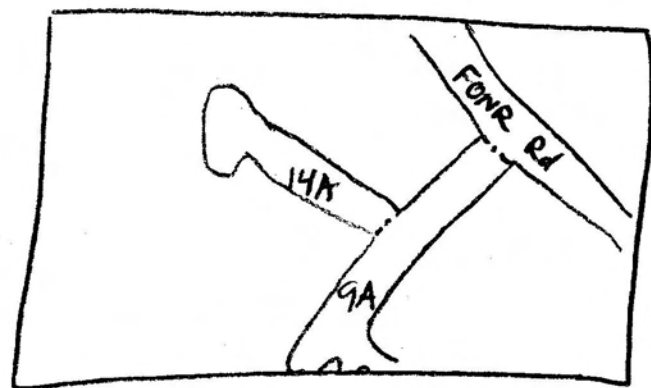

Treatment Key

The treatment key shows an oval labeled 'ceme' with an arrow pointing to it from the text 'Weed Type'. Another arrow points to the outer boundary of the oval from the text 'Boundary of Treated Area'.

NOTE: Photo station ID labels (e.g. ps_01) are placed near photo station locations (P). Direction of photo (i.e. photo point) is labeled with arrow and letter (e.g. P_a -->)

Well ID: MW-OUI-82A
 WCS Sub Group 15A
 Total Aprox. Area 326 (m²)
 Well Rd. Area 208 (m²)
 Well Site Area 118 (m²)

Date 5/27/08
 Surveyor STM, AFM

Legend

- 1A # = WCS Sub Group
- P Photo Station
- Photo Point
- ⊕ Well
- Well Road/Site boundary
- WCS boundary

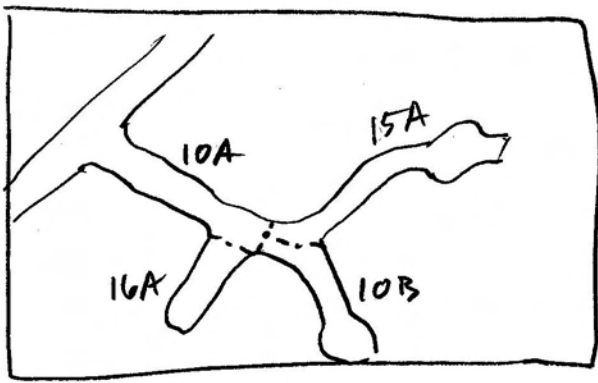

Treatment Key

Boundary of Treated Area

weed Type

NOTE: Photo station ID labels (e.g. ps_01) are placed near photo station locations (P). Direction of photo (i.e. photo point) is labeled with arrow and letter (e.g. P_a -->)

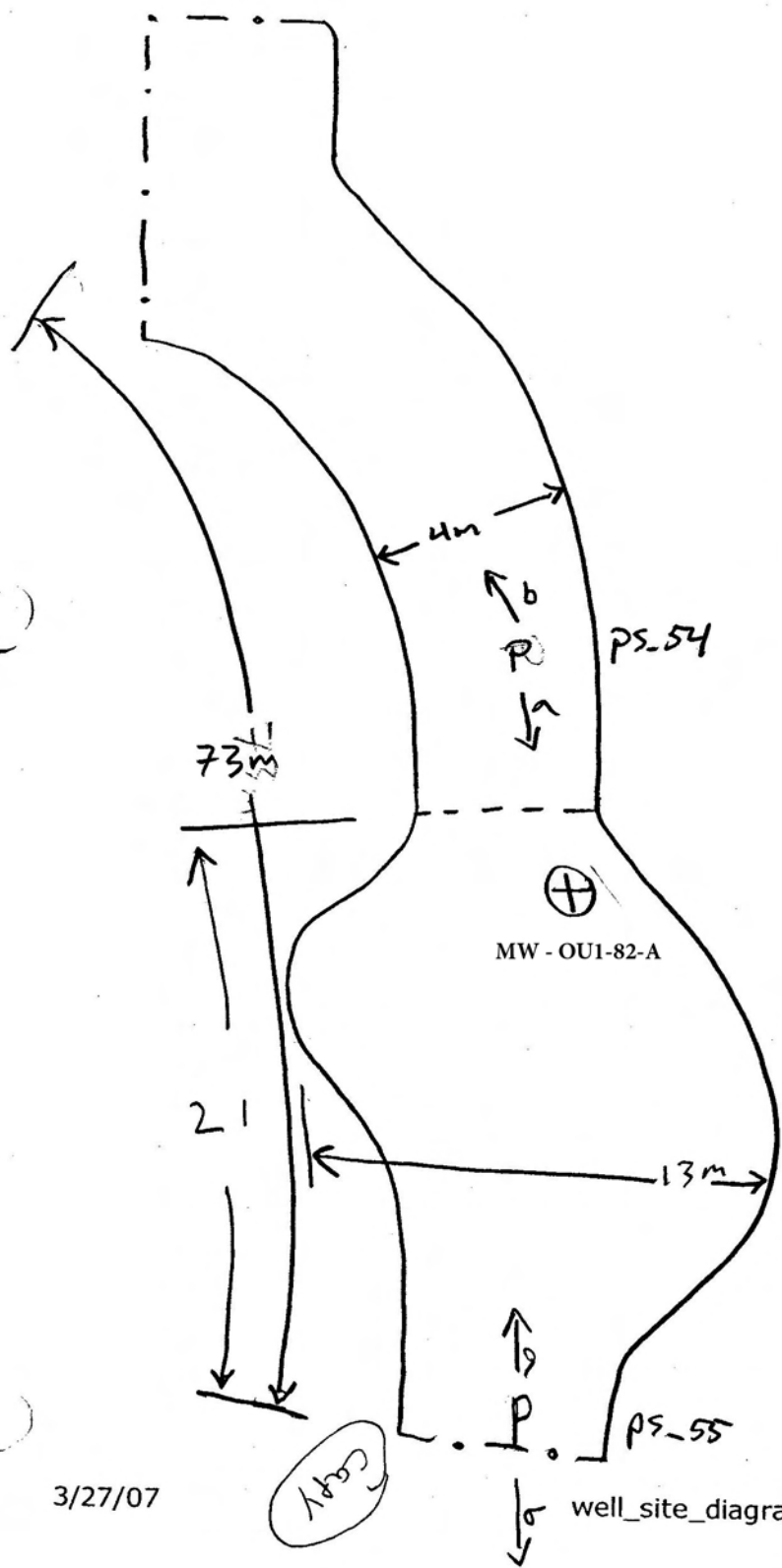

Well ID: SB-OU1-2004K
 WCS Sub Group: 16A
 Total Aprox. Area: 300 (m²)
 Well Rd. Area: 160 (m²)
 Well Site Area: 140 (m²)

Date: 5/27/08
 Surveyor: STM, AFM

Legend

- 1A # = WCS Sub Group
- P Photo Station
- Photo Point
- ⊕ Well
- - - Well Road/Site boundary
- · · WCS boundary

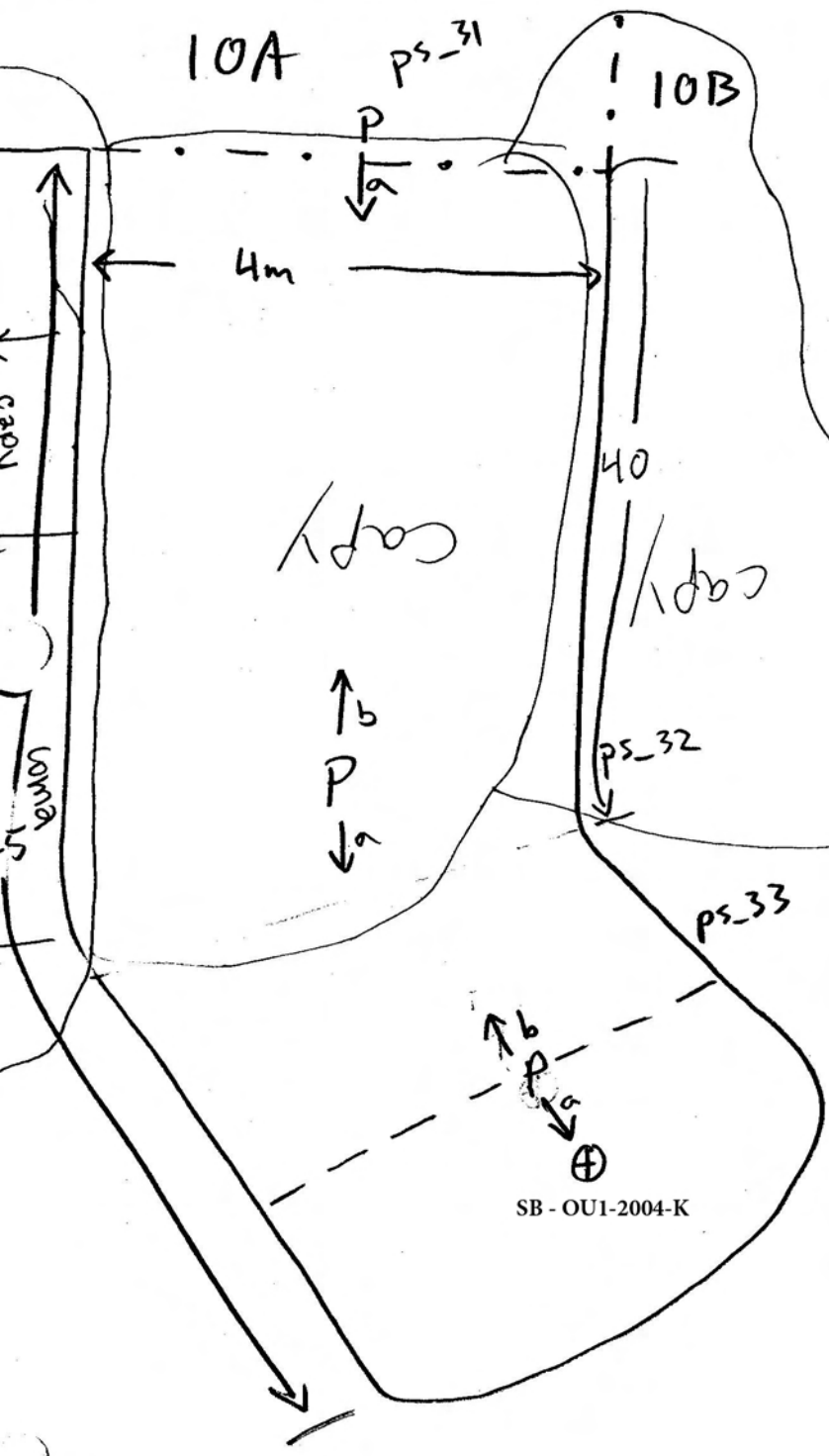
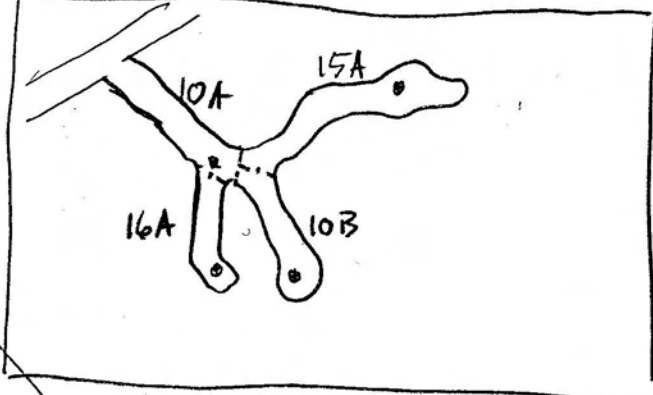

Treatment Key

The diagram shows an oval labeled 'ceme' representing a weed type. An arrow points to the boundary of the oval, labeled 'Boundary of Treated Area'.

NOTE: Photo station ID labels (e.g. ps_01) are placed near photo station locations (P). Direction of photo (i.e. photo point) is labeled with arrow and letter (e.g. P_a -->).

Attachement 2

Photo Log

Photo date	Well	WCS	Photo station	Photo point	Subject	Photo filename	Pre-treatment	Post-treatment	Treatment #	
21-May-08	IW-OU1-01-A	5A	7	a	road	fonr_ps07a_2008-05-21	1			pr
21-May-08	IW-OU1-01-A	5A	7	b	well	fonr_ps07b_2008-05-21	1			pr
21-May-08	IW-OU1-01-A	5A	8	a	road+well	fonr_ps08a_2008-05-21	1			pr
21-May-08	IW-OU1-01-A	5A	8	b	other	fonr_ps08b_2008-05-21	1			pr
21-May-08	IW-OU1-01-A	5A	8	c	road	fonr_ps08c_2008-05-21	1			pr
21-May-08	IW-OU1-05-A	4A	2	a	road+well	fonr_ps02a_2008-05-21	1			pr
21-May-08	IW-OU1-05-A	4A	3	a	well	fonr_ps03a_2008-05-21	1			pr
21-May-08	IW-OU1-05-A	4A	3	b	road	fonr_ps03b_2008-05-21	1			pr
21-May-08	EW-OU1-53-A	6A	10	a	road	fonr_ps10a_2008-08-21	1			pr
21-May-08	EW-OU1-53-A	6A	11	a	road	fonr_ps11a_2008-08-21	1			pr
21-May-08	EW-OU1-53-A	6A	11	b	well	fonr_ps11b_2008-08-21	1			pr
21-May-08	EW-OU1-53-A	6A	12	a	well	fonr_ps12a_2008-08-21	1			pr
21-May-08	EW-OU1-53-A	6A	12	b	other	fonr_ps12b_2008-08-21	1			pr
21-May-08	EW-OU1-52-A	7A	13	a	road	fonr_ps13a_2008-08-21	1			pr
21-May-08	EW-OU1-52-A	7A	14	a	well	fonr_ps14a_2008-08-21	1			pr
27-May-08	MW-OU1-50-A					MW-OU1-50A-59A_fonr_post_constr_photo_comparison_2008-05-27				Nc foi
27-May-08	MW-OU1-59-A	N/A	N/A	N/A	N/A					
27-May-08	SB-OU1-2004-K	16A	31	a	road	fonr_ps31a_2008-05-27	1			pr
27-May-08	SB-OU1-2004-K	16A	32	a	road	fonr_ps32a_2008-05-27	1			pr
27-May-08	SB-OU1-2004-K	16A	32	b	road	fonr_ps32b_2008-05-27	1			pr
27-May-08	SB-OU1-2004-K	16A	33	a	well	fonr_ps33a_2008-05-27	1			pr
27-May-08	SB-OU1-2004-K	16A	33	b	road	fonr_ps33b_2008-05-27	1			pr
27-May-08	MW-OU1-59-A	10B	30	a	well	fonr_ps30a_2008-05-27	1			pr
27-May-08	MW-OU1-59-A	10B	30	b	road	fonr_ps30b_2008-05-27	1			pr
27-May-08	MW-OU1-82-A	15A	54	a	well	fonr_ps54a_2008-05-27	1			pr
27-May-08	MW-OU1-82-A	15A	54	b	road	fonr_ps54b_2008-05-27	1			pr
27-May-08	MW-OU1-82-A	15A	55	a	well	fonr_ps55a_2008-05-27	1			pr
27-May-08	MW-OU1-82-A	15A	55	b	other	fonr_ps55b_2008-05-27	1			pr

Attachement 2

Photo Log

Photo date	Well	WCS	Photo station	Photo point	Subject	Photo filename	Pre-treatment	Post-treatment	Treatment #	
28-May-08	AD PZ-OU1-46-AD2 MW-OU1-46-A	9A	25	a	road	fonr_ps25a_2008-05-28	1			pr
28-May-08	AD PZ-OU1-46-AD2 MW-OU1-46-A	9A	49	a	road	fonr_ps49a_2008-05-28	1			pr
28-May-08	AD PZ-OU1-46-AD2 MW-OU1-46-A	9A	49	b	road+well	fonr_ps49b_2008-05-28	1			pr
28-May-08	AD PZ-OU1-46-AD2 MW-OU1-46-A	9A	49	c	road	fonr_ps49c_2008-05-28	1			SE NO tre
28-May-08	AD PZ-OU1-46-AD2 MW-OU1-46-A	9A	22	a	well	fonr_ps22a_2008-05-28	1			pr
28-May-08	AD PZ-OU1-46-AD2 MW-OU1-46-A	9A	22	b	other	fonr_ps22b_2008-05-28	1			pr
28-May-08	AD PZ-OU1-46-AD2 MW-OU1-46-A	9A	22	c	road	fonr_ps22c_2008-05-28	1			pr
28-May-08	MW-OU1-84-A	9B	51	a	well	fonr_ps51a_2008-05-28	1			pr
28-May-08	IW-OU1-74-A	9C	52	a	road+well	fonr_ps52a_2008-05-28	1			pr
28-May-08	MW-OU1-51-A	9D	52	c	road	fonr_ps52c_2008-05-28	1			pr
28-May-08	MW-OU1-51-A	9D	24	a	well	fonr_ps24a_2008-05-28	1			pr
28-May-08	IW-OU1-73-A	13A	52	b	road	fonr_ps52b_2008-05-28	1			pr
28-May-08	IW-OU1-73-A	13A	53	a	well	fonr_ps53a_2008-05-28	1			pr

Attachement 2

Photo Log

Photo date	Well	WCS	Photo station	Photo point	Subject	Photo filename	Pre-treatment	Post-treatment	Treatment #	
28-May-08	MW-OU1-83-A	14A	49	c	road	fonr_ps49c_2008-05-28	1			D1 W
28-May-08	MW-OU1-83-A	14A	50	a	well	fonr_ps50a_2008-05-28		1		pc
14-Aug-08	IW-OU1-05-A	4A	02	a	road+well	fonr_ps02a_2008-08-14		1		pc
14-Aug-08	IW-OU1-05-A	4A	03	a	well	fonr_ps03a_2008-08-14		1		pc
14-Aug-08	IW-OU1-05-A	4A	03	b	road	fonr_ps03b_2008-08-14		1		pc
14-Aug-08	IW-OU1-01-A	5A	07	a	road	fonr_ps07a_2008-08-14		1		pc
14-Aug-08	IW-OU1-01-A	5A	07	b	well	fonr_ps07b_2008-08-14		1		pc
14-Aug-08	IW-OU1-01-A	5A	08	a	road+well	fonr_ps08a_2008-08-14		1		pc
14-Aug-08	IW-OU1-01-A	5A	08	b	other	fonr_ps08b_2008-08-14		1		pc
14-Aug-08	IW-OU1-01-A	5A	08	c	road	fonr_ps08c_2008-08-14		1		pc
14-Aug-08	EW-OU1-53-A	6A	10	a	road	fonr_ps10a_2008-08-14		1		pc
14-Aug-08	EW-OU1-53-A	6A	11	a	road	fonr_ps11a_2008-08-14		1		pc
14-Aug-08	EW-OU1-53-A	6A	11	b	well	fonr_ps11b_2008-08-14		1		pc
14-Aug-08	EW-OU1-53-A	6A	12	a	well	fonr_ps12a_2008-08-14		1		pc
14-Aug-08	EW-OU1-53-A	6A	12	b	other	fonr_ps12b_2008-08-14		1		pc
14-Aug-08	EW-OU1-52-A	7A	13	a	road	fonr_ps13a_2008-08-14		1		pc
14-Aug-08	EW-OU1-52-A	7A	14	a	well	fonr_ps14a_2008-08-14		1		pc
14-Aug-08	AD PZ-OU1-46- AD2 MW-OU1- 46-A	9A	25	a	road	fonr_ps25a_2008-08-14		1		pc
14-Aug-08	AD PZ-OU1-46- AD2 MW-OU1- 46-A	9A	49	a	road	fonr_ps49a_2008-08-14		1		pc
14-Aug-08	AD PZ-OU1-46- AD2 MW-OU1- 46-A	9A	49	b	road	fonr_ps49b_2008-08-14		1		pc

Attachement 2

Photo Log

Photo date	Well	WCS	Photo station	Photo point	Subject	Photo filename	Pre-treatment	Post-treatment	Treatment #
14-Aug-08	AD PZ-OU1-46-AD2 MW-OU1-46-A	9A	49	c	road	fonr_ps49c_2008-08-14		1	po
14-Aug-08	AD PZ-OU1-46-AD2 MW-OU1-46-A	9A	22	a	well	fonr_ps22a_2008-08-14		1	po
14-Aug-08	AD PZ-OU1-46-AD2 MW-OU1-46-A	9A	22	b	other	fonr_ps25a_2008-08-14		1	po
14-Aug-08	AD PZ-OU1-46-AD2 MW-OU1-46-A	9A	22	c		fonr_ps22c_2008-08-14		1	po
14-Aug-08	MW-OU1-84-A	9B	51	a	well	fonr_ps51a_2008-08-14		1	po
14-Aug-08	IW-OU1-74-A	9C	52	a	road+well	fonr_ps52a_2008-08-14		1	po
14-Aug-08	MW-OU1-51-A	9D	52	c	road	fonr_ps52c_2008-08-14		1	po
14-Aug-08	MW-OU1-51-A	9D	24	a	well	fonr_ps24a_2008-08-14		1	po
14-Aug-08	MW-OU1-50-A	10A	28	a	road	fonr_ps28a_2008-08-14		1	po
14-Aug-08	MW-OU1-50-A	10A	29	a	well	fonr_ps29a_2008-08-14		1	po
14-Aug-08	MW-OU1-50-A	10A	29	b	road	fonr_ps29b_2008-08-14		1	po
14-Aug-08	MW-OU1-50-A MW-OU1-59-A	10B	30	a	well	fonr_ps23a_2008-08-14		1	po
14-Aug-08	MW-OU1-50-A MW-OU1-59-A	10B	30	b	road	fonr_ps30b_2008-08-14		1	po
14-Aug-08	IW-OU1-73-A	13A	52	b	road	fonr_ps52b_2008-08-14		1	po
14-Aug-08	IW-OU1-73-A	13A	53	a	well	fonr_ps53a_2008-08-14		1	po
14-Aug-08	MW-OU1-83-A	14A	49	c	road	fonr_ps49c_2008-08-14		1	po
14-Aug-08	MW-OU1-83-A	14A	50	a	well	fonr_ps50a_2008-08-14		1	du 14
14-Aug-08	MW-OU1-82-A	15A	54	a	well	fonr_ps54a_2008-08-14		1	po

Attachement 2
Photo Log

Photo date	Well	WCS	Photo station	Photo point	Subject	Photo filename	Pre-treatment	Post-treatment	Treatment #	
14-Aug-08	MW-OU1-82-A	15A	54	b	road	f0nr_ps54b_2008-08-14		1		po
14-Aug-08	MW-OU1-82-A	15A	55	a	well	f0nr_ps55a_2008-08-14		1		po
14-Aug-08	MW-OU1-82-A	15A	55	b	other	f0nr_ps55b_2008-08-14		1		po
14-Aug-08	SB-OU1-2004-K	16A	31	a	road	f0nr_ps31a_2008-08-14		1		po
14-Aug-08	SB-OU1-2004-K	16A	32	a	road	f0nr_ps32a_2008-08-14		1		po
14-Aug-08	SB-OU1-2004-K	16A	32	b	road	f0nr_ps32b_2008-08-14		1		po
14-Aug-08	SB-OU1-2004-K	16A	33	a	well	f0nr_ps33a_2008-08-14		1		po
14-Aug-08	SB-OU1-2004-K	16A	33	b	road	f0nr_ps33b_2008-08-14		1		po

Attachment 3

‘HGL_WCS_Photos_2008’

The attached compact disc contains photographs taken during the 2008 weed control performed by UCSC staff. Photographs on the compact disc are organized in folders.

Each folder contains photos of the HGL Weed Control Segments (well sites and associated access roads) from the spring 2008 field season. Each folder name refers to

identifying name for each well site (e.g. EW-OU1-52-A).

Each folder contains photos (.jpg files) with names designating the reserve (forn), the photo station number (‘_ps#’), and the date the photo was taken (_year-month-day).

e.g. ‘forn_ps13a_2008-05-21’
‘forn_ps13a_2008-08-14’

Each photo station has at least two photos, one pre-treatment and one post-treatment, designated by date of photo.

Also, refer to photo log (HGL_WCS_Photo_Log_2008.xls) for more detailed information.