

## **Appendix C. Posttransfer Modifications to the HMP**

---

The text and map modifications described in the following correspondence are not reflected in the main text but in the maps of this appendix.

| <b>Parcel Number</b> | <b>Recipient</b>         | <b>Date</b>       |
|----------------------|--------------------------|-------------------|
| L.51.11              | City of Marina           | November 25, 1996 |
| S.2.15               | University of California | November 25, 1996 |

UNIVERSITY OF CALIFORNIA, SANTA CRUZ

BERKELEY • DAVIS • IRVINE • LOS ANGELES • RIVERSIDE • SAN DIEGO • SAN FRANCISCO



SANTA BARBARA • SANTA CRUZ

COMMUNITY PLANNING AND LAND DEVELOPMENT

SANTA CRUZ, CALIFORNIA 95064

November 25, 1996

Cathy McCalvin  
US Fish and Wildlife Service  
Ventura Field Office  
2493 Portola Road, Suite B  
Ventura California 93003

Re: Adjustments to HMP Map

Dear Ms. McCalvin

At an October 22, 1996 Fort Ord Habitat Management Plan All Hands meeting Bob Verkade of the US Army Corps of Engineers stated to the University of California and the City of Marina that long-standing requests for changes to the Installation-Wide Multispecies Habitat Management Plan (HMP) map could be made if the Army received concurrence from the US Fish and Wildlife Service. On October 25 and October 28 the University of California and the City of Marina, respectively, sent requests to you for changes to the HMP map. On November 18 US Fish and Wildlife Field Supervisor Diane Noda sent comments on the HMP to Bob Verkade. Those comments included concurrence with the City of Marina and University of California requests. At the November 21 All Hands meeting, Mr. David Taylor of the US Army Training and Doctrine Command overruled Bob Verkade's previous statement, saying that the HMP map itself could not be altered, but that a section of the full map could be included within the text of the HMP indicating the changes that had been proposed by the University of California and the City of Marina and with which the US Fish and Wildlife Service concurred. Following that meeting, Bob Verkade confirmed that such a change could be made provided that a request were to be sent to him from the US Fish and Wildlife Service. We therefore ask that you send a letter to Bob Verkade requesting that the following changes be made to the November 6 version of the HMP.

Page 4-21, line 27, add the following sentence to the end of the paragraph: "The eastern edge of this parcel was adjusted as shown in Figure 4-x following transfer of land to the University of California. The adjustment results in no change in the overall size of this parcel."

Page 4-23, line 11, add the following sentence to the end of the paragraph: "The northern edge of this parcel was adjusted as shown in Figure 4-x following transfer of land to the University of California. The adjustment results in no change in the overall size of this parcel."

Page 4-35, line 16, add the following sentence to the end of the paragraph: "The northern edge of this parcel was adjusted as shown in Figure 4-x following transfer of land to the City of Marina. The centerline of a Right of Way for a major arterial roadway will be relocated to follow the new northern boundary of this parcel. The adjustment results in no change in the overall size of this parcel."

Please ask the Army to use the three enclosed graphics to create one or two section maps that can be inserted into the HMP near the referenced text.

Thank you for supporting our requests. Please call if you have any further questions.



---

Graham Bice, Director  
Physical and Environmental Planning  
UC MBEST Center

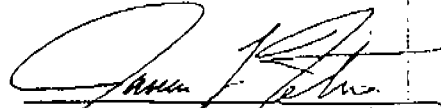

---

for Jeff Dack, Director  
Planning Department  
City of Marina

enclosures (3)

cc: Lora Martin  
John Longley  
Bob Verkade



1994 HAP Boundary

Mapped Sand  
gilias

Proposed  
New  
Boundary

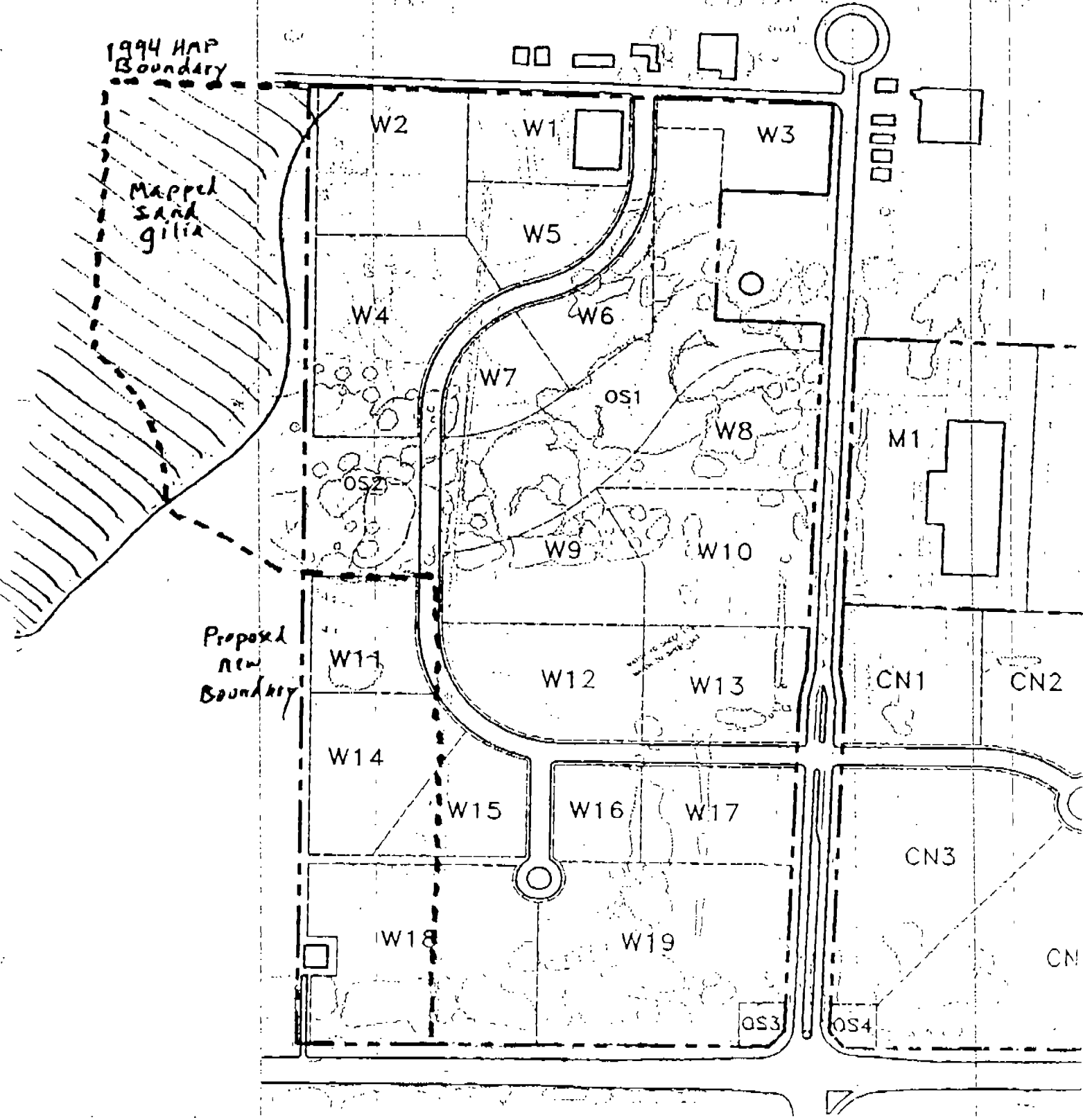

ATTACHMENT 2

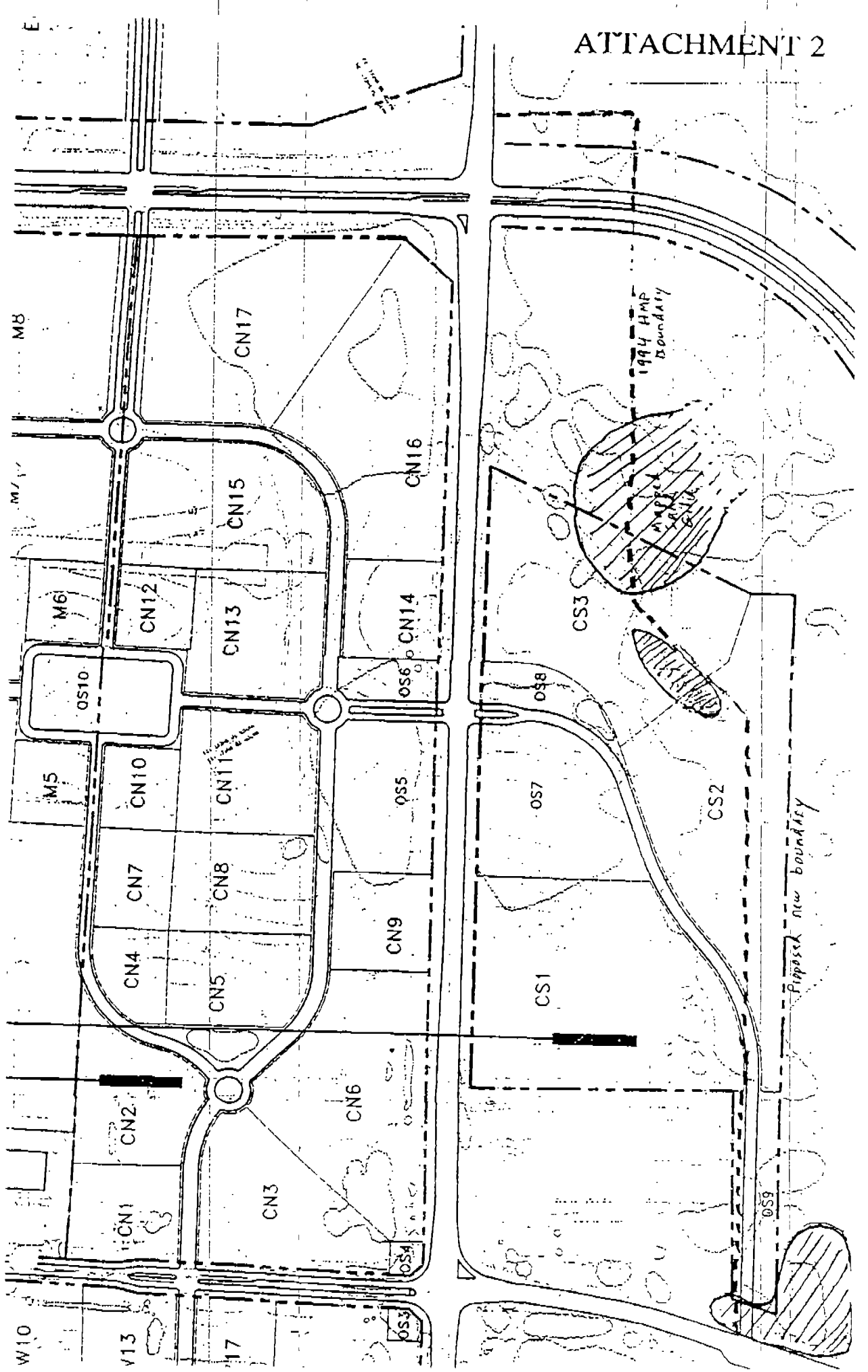



COMMUNITY PLANNING AND LAND DEVELOPMENT

SANTA CRUZ, CALIFORNIA 95064

January 15, 1996

Bob Verkade  
U.S. Army Corps of Engineers  
1325 J Street  
12th Floor, Room 143  
Sacramento, California, 95814

Subject: Clarification of November 25, 1996 letter to U.S. Fish and Wildlife Service

Dear Mr. Verkade,

On November 25, 1996 we issued a joint letter to Cathy McCalvin, of the U.S. Fish and Wildlife Service, requesting concurrence on suggested boundary changes to the large map appearing in the Installation-Wide Multispecies Habitat Management Plan for Former Fort Ord, California (HMP). The U.S. Army Corps of Engineers chose to note in the text that a change had been made to the large map and include our joint letter in Appendix C of the December 1996 version of the HMP.

Following publication of the December, 1996 version of the HMP we noticed that Attachment 3 of our letter included a planned roadway shown to cross a portion of the UC/NRS Fort Ord Natural Reserve. This planned roadway alignment was not a part of the HMP and is not a part of our requested boundary change, but is included in the City of Marina General Plan, which was the source of the base map used for Attachment 3 of our November 25, 1996 letter. To avoid potential confusion regarding the meaning of the roadway shown on Attachment 3, we request that the final printing of the HMP replace the Attachment 3 you received with the enclosed sheet. The enclosed sheet is identical to the original Attachment 3 with the addition of the the following text, located near the bottom of the page: "Alignment of California Avenue as shown in City of Marina General Plan, not part of the HMP".

We hope you will agree that this clarification is appropriate.

Handwritten signature of Graham Bice.

Graham Bice, Director  
Physical and Environmental Planning  
UC MBEST Center

Handwritten signature of Jeff Back.

Jeff Back, Director  
Planning Department  
City of Marina

enclosure (1)

cc: Lora Martin, John Longley, Cathy McCalvin, Cathy Klack

CHANGE FROM VISITOR  
SERVING TO HABITAT  
MANAGEMENT (ADD  
TO LR 5)

HABITAT  
MANAGEMENT

VISITOR  
SERVING

CHANGE FROM  
HABITAT TO  
VISITOR SERVING  
(ADD TO LR 17)

Alignment of California Avenue as shown in  
City of Marina General Plan, not part of HMIP

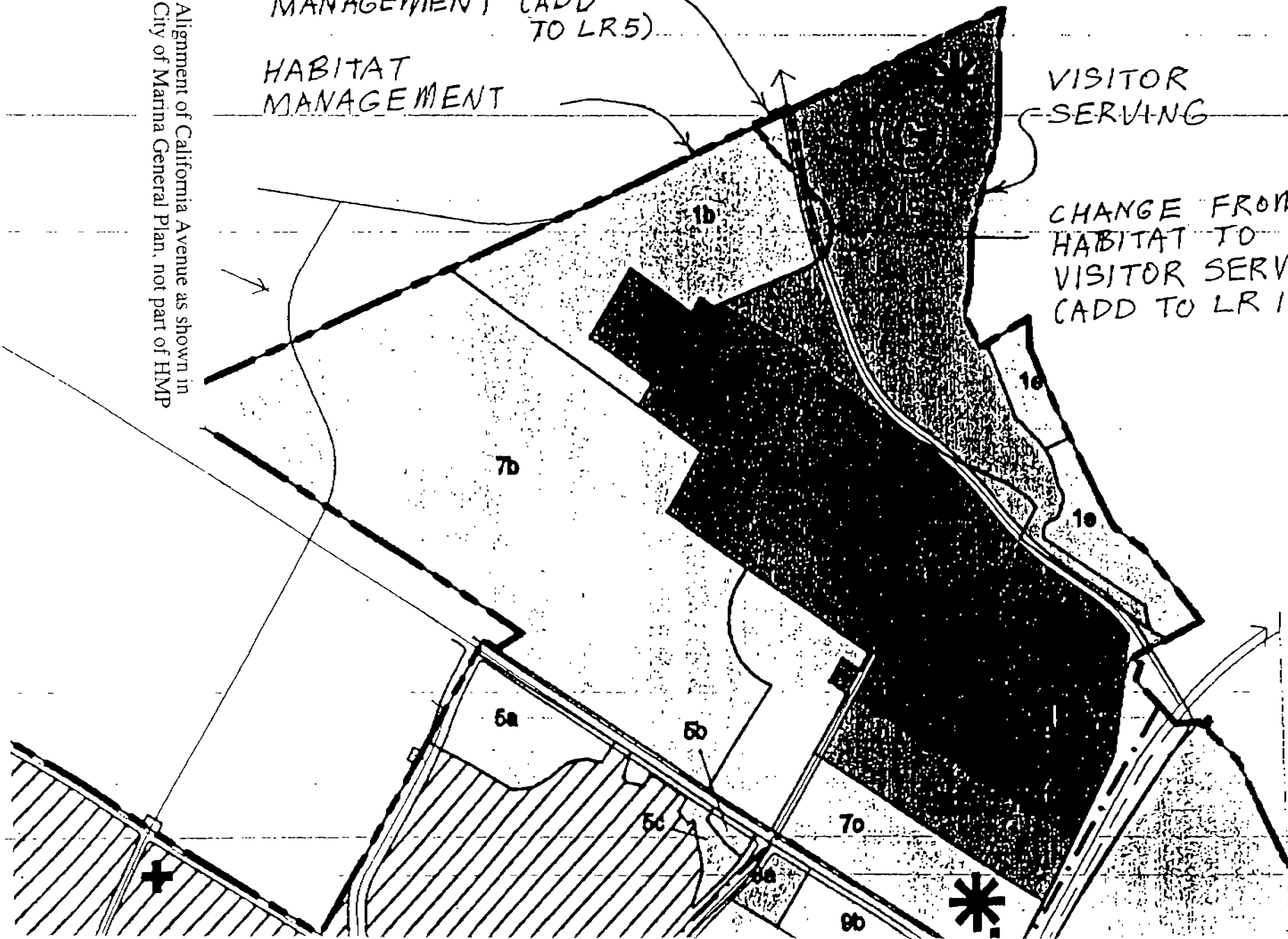

ATTACHMENT 3

Marina Parcels, scale 1" = 500'

|                   |               |         |                |            |   |
|-------------------|---------------|---------|----------------|------------|---|
| Post-It® Fax Note | 7671          | Date    | 12/3           | # of pages | 2 |
| To                | Graham Bice   | From    | Bruce Boyd     |            |   |
| Co./Dept.         | UC Santa Cruz | Co.     | Jones & Stokes |            |   |
| Phone #           | 408-423-9893  | Phone # | 916/737-3000   |            |   |
| Fax #             | 408-582-1021  | Fax #   | 916/737-3030   |            |   |

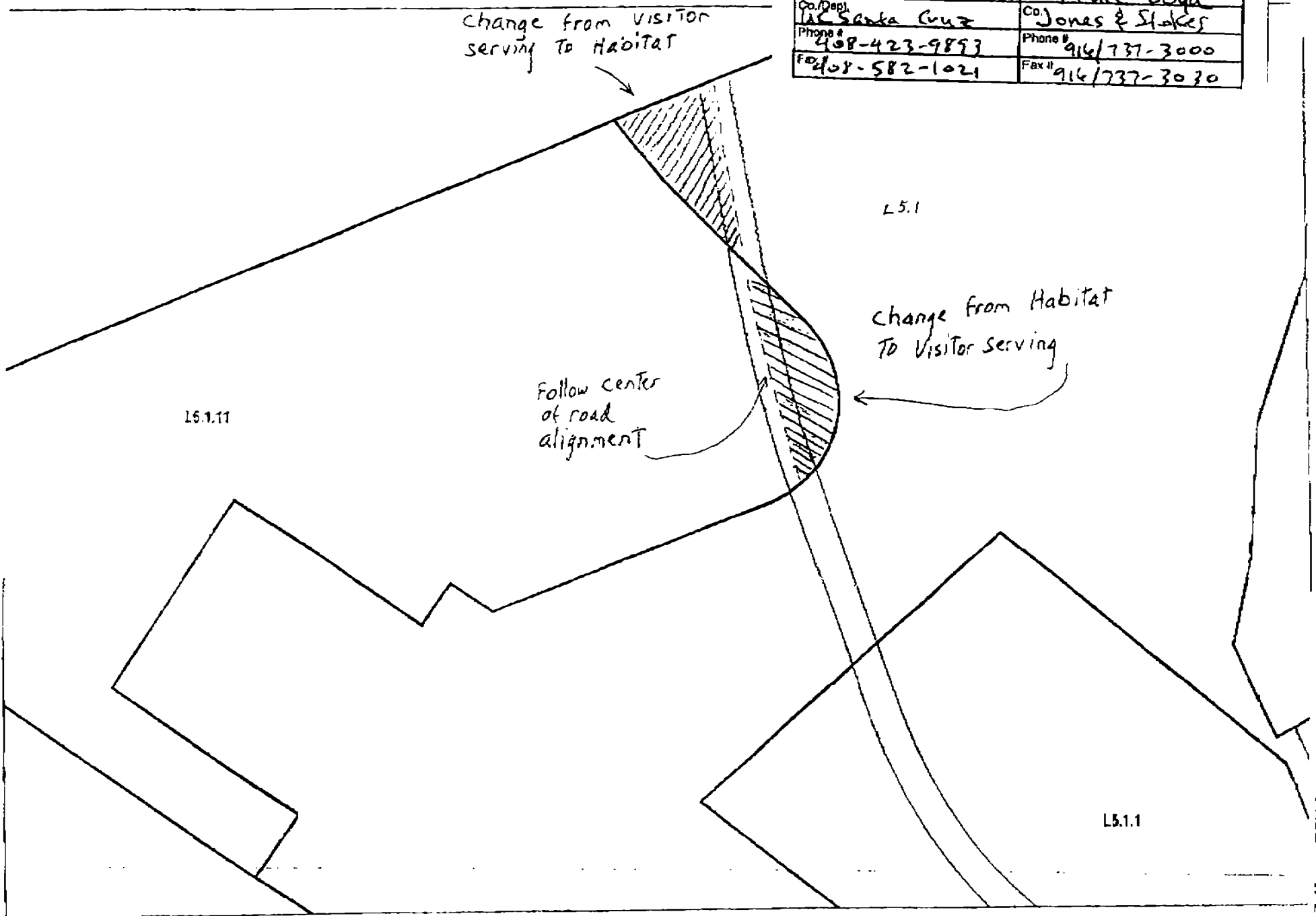



# UC Santa Cruz Parcels, scale 1" = 800'

DEC-03-88 11.56 FROM JONES & STOKES ASSOCIATES ID:

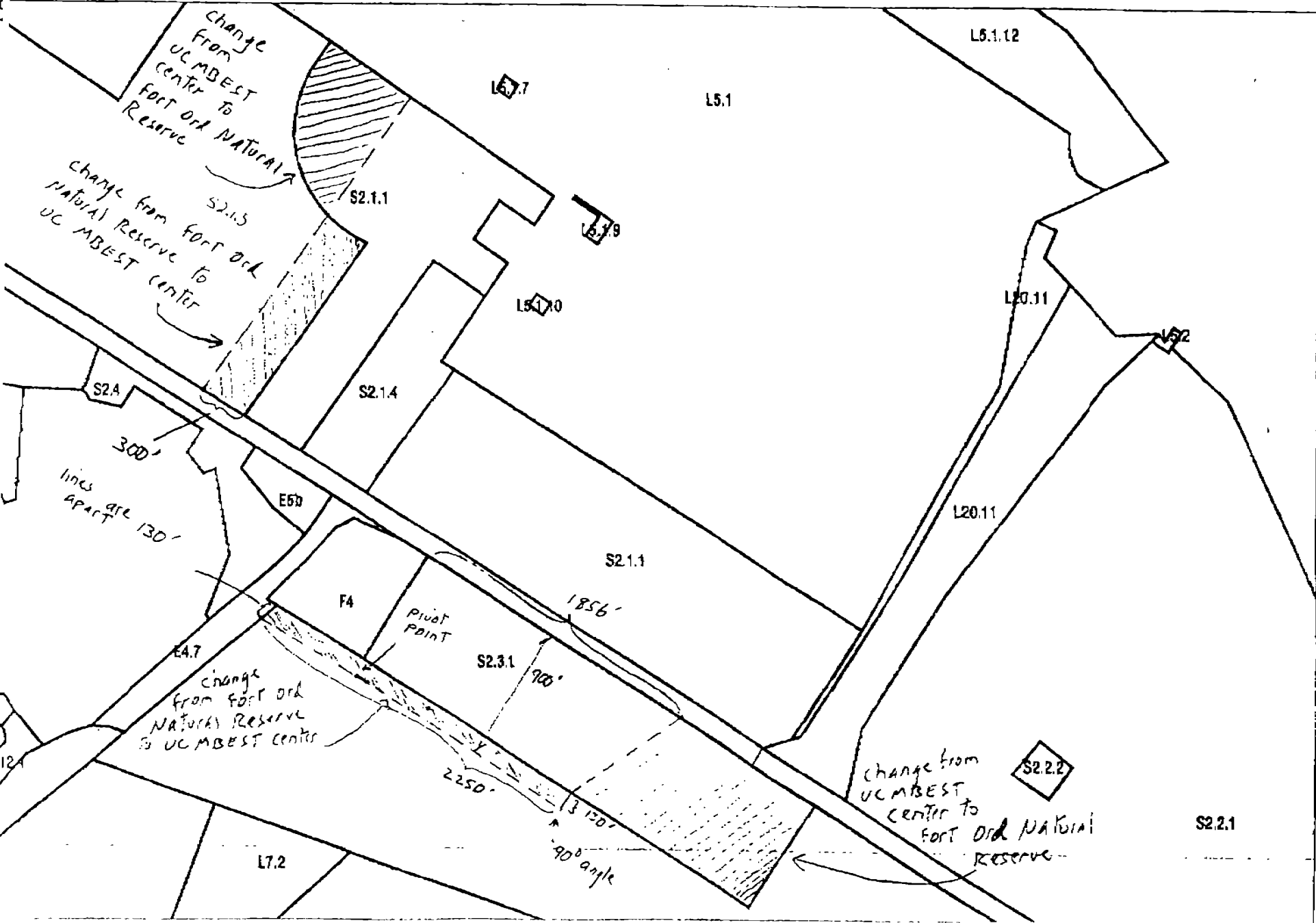



# United States Department of the Interior

## FISHLAND WILDLIFE SERVICE

Ecological Services  
Ventura Field Office  
2490 Fortohn Road, Suite B  
Venture, California 93008

December 4, 1996

Bob Verkade  
U.S. Army Corps of Engineers  
1325 J Street  
12th Floor, Room 143  
Sacramento, California 95814

OPTIONAL FORM NO. 10 (7-90)

### FAX TRANSMITTAL

|                        |          |                                 |
|------------------------|----------|---------------------------------|
| To: <i>Bob Verkade</i> | Print    | # of pages <i>2</i>             |
| Dept/Agency            | Phone #  | <i>219-7</i>                    |
| Fax #                  | Fax #    |                                 |
| NSN 7540-01-317-7028   | 5080-101 | GENERAL SERVICES ADMINISTRATION |

Subject: Adjustments to HMP Map

Dear Mr. Verkade:

Based on the information provided us by the City of Marina (City) and the University of California (U.C.) in letters dated October 28, 1996 and October 25, 1996 respectively, we concur that their proposed boundary changes would not alter the intent of the Habitat Management Plan (HMP) and would not reduce the protection of any HMP species. Therefore, we recommend that the Department of Army make the requested boundary changes to the November 6 version of the HMP as described to us in these letters. The HMP should incorporate the maps developed by the City and U.C. that depict the boundary changes. In addition, the following changes should be made to the HMP text:

Page 4-21, line 27, add the following sentence to the end of the paragraph: "The edge of this parcel was adjusted as shown in Figure 4-x following transfer of land to the University of California. The adjustment results in no change in the overall size of this parcel."

Page 4-23, line 16, add the following sentence to the end of the paragraph: "The northern edge of this parcel was adjusted as shown in Figure 4-x following transfer of land to the University of California. The adjustment results in no change in the overall size of this parcel."

Page 4-35, line 16, add the following sentence to the end of the paragraph: "The northern edge of this parcel was adjusted as shown in Figure 4-x following transfer of land to the City of Marina. The centerline of a Right of Way for a major arterial road

Bob Verkade

2

will be relocated to follow the new northern boundary of this parcel. The adjustment results in no change in the overall size of this parcel.

If you have any questions about the requested adjustments, please contact Cathy Mc Calvin on my staff at (805) 614- 1766.

Sincerely,

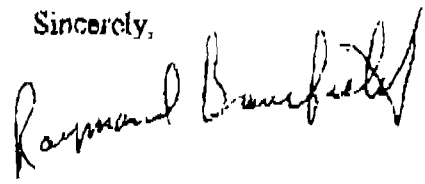

for

Diane Noda  
Field Supervisor