

**EXPLANATION**

- ◆ SOIL BORING (HLA)
- ◆ SOIL BORING (BY OTHERS)
- ◆ MONITORING WELL (BY OTHERS)

**POSTING OF CHEMICALS USING BOXES**

**11.88** BOLDED CONCENTRATIONS EXCEEDED PRG

SAMPLE LOCATION  
SAMPLE DEPTH IN FEET BELOW GROUND SURFACE

SB-05-14	0.00	5.5
HMX	1.84	ND(0.40)
RDX	16.5	ND(0.256)

(REPORTING LIMIT)

CONCENTRATIONS IN MILLIGRAMS PER KILOGRAM (mg/kg)

ANALYTES INCLUDES DETECTED EXPLOSIVE COMPOUNDS. ABBREVIATIONS ARE DEFINED IN THE LIST OF ACRONYMS AND ABBREVIATIONS.

(S) DENOTES SPLIT SAMPLE

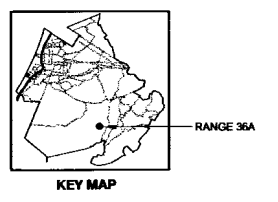
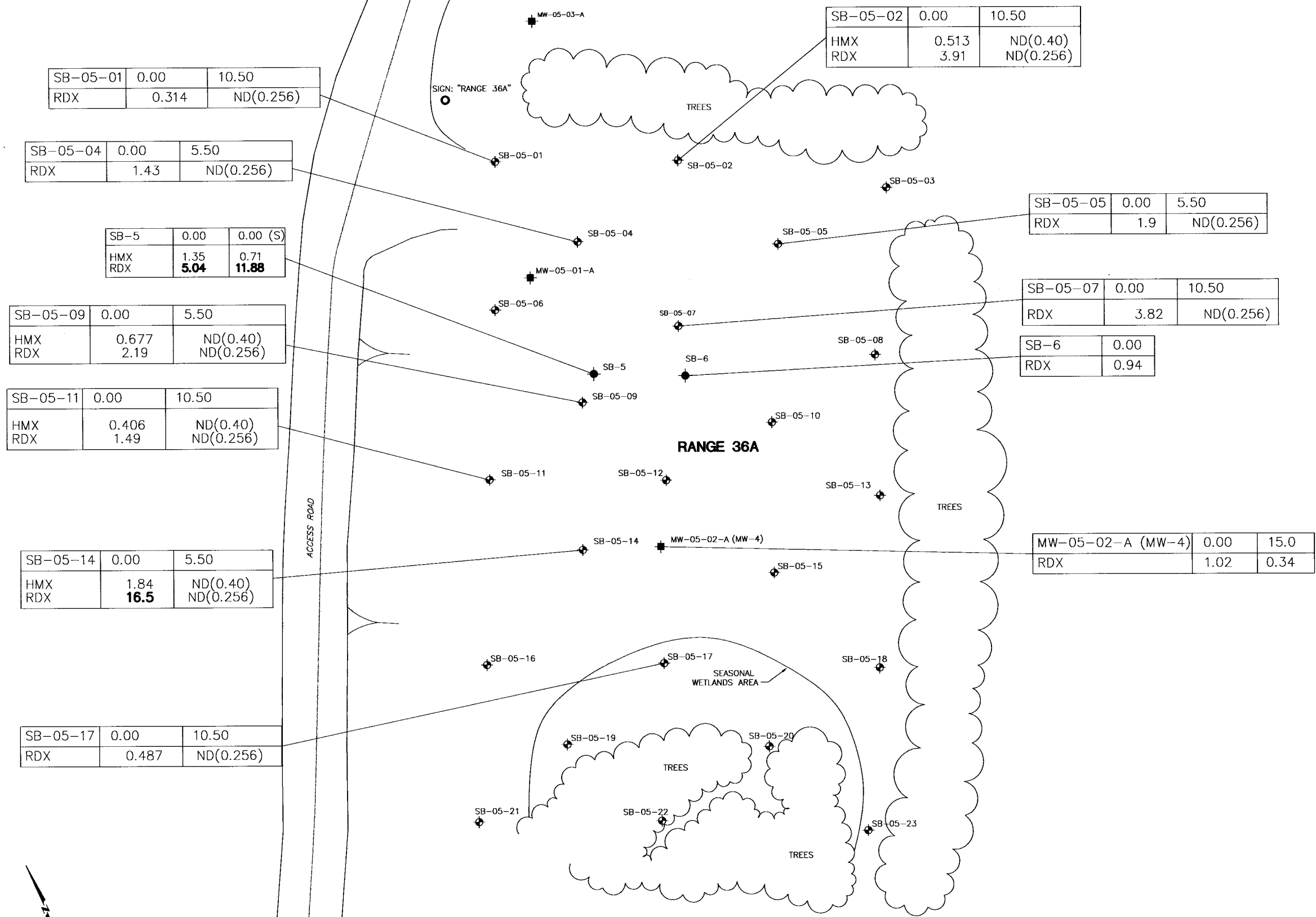

NO.	DATE	REVISIONS	HIA FILE NO.	PROJECT NO.	APPROVED	APPROVAL DATE	DRAWN BY
1		DRAFT	23366C12.DWG	23366 098713	<i>[Signature]</i>	02/05/04	PH



**RCRA Closure Plan  
Range 36A (SWMU FTO-016)  
Former Fort Ord, California**

**Site Map and Previous Investigation Results  
Distribution of Explosive Compounds  
Detected in Soil**